

TOTAL SYSTEMS SOLUTIONS WORLDWIDE™



## **300/400 Series™ Pumps and Motors**

*Pressure to 3500 PSI*

*Pumps with flows to over 90 GPM*

*Motors with outputs to over 150 HP*



# General Information

## P300 Series Pumps & Motors

- Three-piece cast iron construction
- Low friction bushing design
- Heavy-duty application
- Single, multiple, piggyback and thru-drive assemblies

The Commercial Hydraulics 300 Series pumps and motors set the standard for superior performance and reliability in heavy-duty hydraulic application. The three-piece cast iron construction with large area, low-friction bushings provide strength, high efficiency, and long life in severe operating environments. The design includes an advanced thrust plate and seal configuration, which optimizes performance even in high temperature and low viscosity conditions.

300 Series pumps are available in single, multiple, piggyback, and thru-drive assemblies. Multiple pumps reduce mounting costs, allow for a small package size and common inlet capabilities. Assemblies up to six pumping sections are available. Piggyback pumps allow the combination of pump sections of different frame size in a common inlet, tandem configuration, while the thru-drive feature allows an independent piston or gear pump to be mounted to a rear SAE drive pad. Multiple section motors are also available providing enhanced torque and speed control as well as smooth torque ripple.

Relief valve, priority valve, load-sense unloading, and other integrated or bolt-on valve options are also available.

Model P = Pump M = Motor Options D = Stealth	Theoretical Displacement  in <sup>3</sup> /r - cm <sup>3</sup> /r		Mineral Oil Maximum Pressure			
			Continuous psi - bar		Intermittent psi - bar	
<b>P315</b> <b>M315</b>	.620	10.2	3500	245	4000	275
	.775	12.7	3500	245	4000	275
	.930	15.2	3500	245	4000	275
	1.09	17.8	3500	245	4000	275
	1.24	20.3	3500	245	4000	275
	1.40	22.9	3500	245	4000	275
	1.55	25.9	3500	245	3850	265
	1.71	27.9	3500	245	3700	255
	1.86	30.5	3300	225	3500	245
	2.02	33.0	3100	215	3350	230
	2.17	35.6	2900	200	3100	215
	2.33	38.1	2700	190	2950	205
2.48	40.6	2500	175	2750	190	
<b>P330</b> <b>M330</b>	.985	16.1	3500	245	4000	275
	1.47	24.2	3500	245	4000	275
	1.97	32.3	3500	245	4000	275
	2.46	40.4	3500	245	4000	275
	2.95	48.4	3500	245	3850	265
	3.44	56.5	3250	225	3500	245
<b>P350</b> <b>M350</b>	3.94	64.6	3000	210	3300	225
	1.28	20.9	3500	245	4000	275
	1.91	31.3	3500	245	4000	275
	2.55	41.8	3500	245	4000	275
	3.19	52.2	3500	245	4000	275
	3.82	62.7	3500	245	3850	265
	4.46	73.1	3250	225	3500	245
	5.10	83.6	3000	210	3300	225
	5.73	94.0	2750	190	3000	210
	6.38	104.5	2500	175	2750	190
<b>P365</b> <b>M365</b>	2.70	44.3	3500	245	4000	275
	3.60	59.0	3500	245	4000	275
	4.50	73.8	3500	245	4000	275
	5.40	88.5	3500	245	4000	275
	6.30	103.3	3500	245	4000	275
	7.20	118.0	3500	245	3850	265
	8.10	132.8	3250	225	3500	245
	9.00	147.5	3000	210	3300	225

# PL Factor

Each section of a multiple pump or motor should be regarded as a single unit with corresponding delivery and power input requirements. Since the entire input horsepower is fed through a common drive shaft, the power delivered to or from the unit is limited by the physical strength of the shaft. This limit is defined as a "PL" factor; "P" being the operating pressure and "L" the summation of gear widths.

In multiple units the "PL" must be calculated for the first connecting shaft as well as the drive shaft. Each style or type of shaft has a unique "PL" factor as noted in the table below.

$$\text{Pressure X Total Gear Width} = \text{PL}$$

PL MUST NOT EXCEED NUMBER SHOWN IN CHART FOR APPROPRIATE SHAFT.

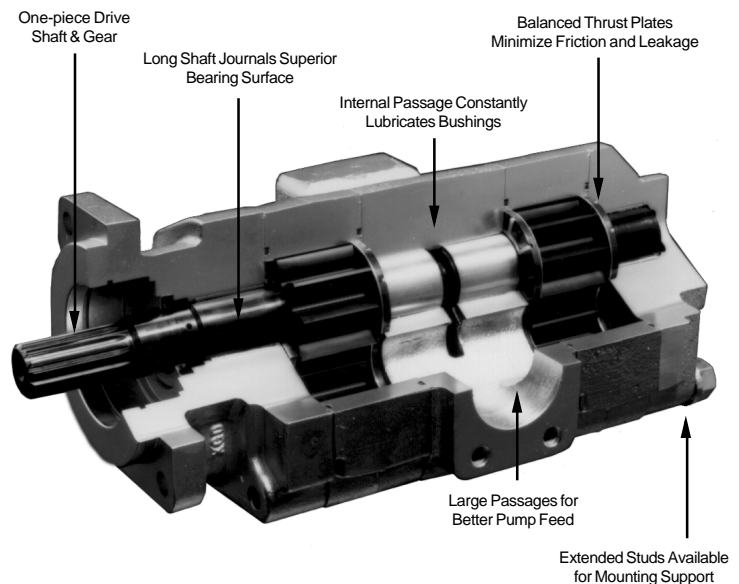
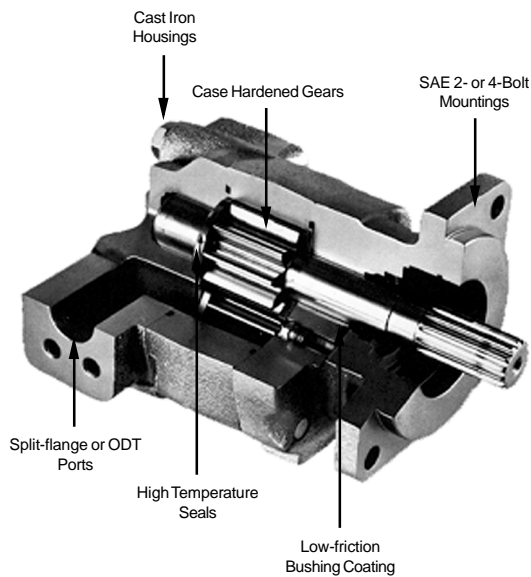

PL Chart		
Shaft Style	Integral Shaft & Gear	Two-Piece Style
<b>315</b>		
SAE "A" Spline <i>(up to 1.25" GW)</i>	4,450	--
SAE "A" Key	3,600	--
SAE "B" Spline	13,400	--
SAE "B" Key	9,900	--
Connecting Shaft	--	5,550
<b>330</b>		
SAE "B" Spline	8,450	6,250
SAE "B" Key	6,250	6,250
SAE "B-B" Spline	13,000	6,250
SAE "B-B" Key	9,300	6,250
SAE "C" Spline	--	6,250
SAE "C" Key	--	6,250
Connecting Shaft	--	6,250
<b>350</b>		
SAE "B" Spline	6,450	4,500
SAE "B" Key	4,750	4,750
SAE "B-B" Spline	9,900	9,000
SAE "B-B" Key	7,100	7,100
SAE "C" Spline	19,100	9,000
SAE "C" Key	13,900	9,000
Connecting Shaft	--	9,000
<b>365</b>		
SAE "B" Spline	5,050	3,500
SAE "B" Key	3,700	3,700
SAE "B-B" Spline	7,750	5,350
SAE "B-B" Key	5,550	5,550
SAE "C" Spline	14,900	11,950
SAE "C" Key	10,800	10,800
Connecting Shaft	--	11,950

# General Data

## Pump Type

Heavy duty, cast iron, external gear pump

## Mounting

SAE standard flanges, ZF, others

## Porting

SAE split flanges and other types of threaded ports (see table)

## Shaft Style

SAE splined, keyed, and others (see table)

## Drive

Clockwise, counterclockwise, double. Direct drive with flexible coupling is recommended. Pumps subject to radial loads must be specified with an outward bearing. Axial loading is not allowed.

## Speed

From 400 to 3000 rev/min

## Theoretical displacements

See table

## Maximum radial loads with outboard bearing

P 315 3200 N (only SEC - 90)

P 330 3500 N

P 350 5000 N

P 365 6500 N

## Inlet pressure

30 psi/0,8 to 2,0 bar absolute at operating temperature

## Outlet pressure

See table

## Hydraulic fluids

Mineral oil, fire resistant fluids:

- water-oil emulsions 60/40, HFB
- water-glycol, HFC
- phosphate-esters, HFD

## Fluid temperature

Mineral oil with standard seals:

0° F to 180° F (-20° C to +80° C)

Fire resistant fluids HFB, HFC

0° F to 180° F (-20° C to +60° C)

## Fluid velocity

From 7, 5 to 1600 cSt (50 to 7500 sus)

Recommended 15 to 75 cSt

## Filtration

ISO 4406 code:

- 19/16 at 2000 psi/ 140 bar
- 17/14 at 3000 psi/ 210 bar
- 15/12 at 4000 psi/ 275 bar

## Flow velocity

Mineral oil and HFD:

- Inlet up to 8 fps/ 2,5 m/s
- Outlet up to 18 fps/ 6,0 m/s
- Fire resistant fluids HFB, HFC
- Inlet up to 5 fps/ 1,5 m/s
- Outlet up to 13 fps/ 4,0 m/s

## Multiple pump assemblies

Up to 6 gear sections of the same model, even with different gear widths

## Piggyback assemblies

Several models can be mounted together, one at the rear of the other. Fluids are intermixing even from separate reservoirs: 300/315, 350/315, 365/330, 365/330/315

## Add-a-pump assemblies

Similar to piggyback, but fluids are not intermixing.

330/Al (Al: aluminum pumps)

350/Al, 350/330, 350/350, 365/Al, 365/330, 365/350

## Pumps with priority outlet

Available for models 315, 330, 350

- For operation outside given parameters, please consult the Commercial representative in your area.
- The smallest gear width of each model is not recommended for single units at the maximum rated pressure
- Theoretical displacement is equal to the theoretical flow at 1000 rev/min.

# Porting

## SAE Flanged Ports Metric Thread (SSM)

Port Size		A	B	C	D
inch	mm	mm	mm	mm	mm
0,50	12,7	17,5	38,1	M8x1,25	23,9
0,75	19,1	22,2	47,6	M10x1,50	22,4
1,00	25,4	26,2	52,2	M10x1,50	22,4
1,25	31,8	30,2	58,7	M10x1,50	28,4
1,50	36,1	35,7	69,9	M12x1,75	26,9
2,00	50,8	42,9	77,8	M12x1,75	26,9
2,50	63,5	50,8	88,9	M12x1,75	30,2

## SAE Flanged Ports UNC Thread (SSS)

Port Size		A	B	C	D
inch	mm	mm	mm	mm	mm
0,50	12,7	17,5	38,1	5/16"-18	23,9
0,75	19,1	22,2	47,6	3/8"-16	22,4
1,00	25,4	26,2	52,2	3/8"-16	22,4
1,25	31,8	30,2	58,7	7/16"-14	28,4
1,50	36,1	35,7	69,9	1/2"-13	26,9
2,00	50,8	42,9	77,8	1/2"-13	26,9
2,50	63,5	50,8	88,9	1/2"-13	30,2

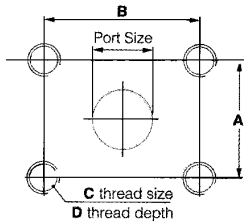

# Drive Shaft

## Maximum Input Torque

Shaft Style		• integral: ;	P315	P330	P350	P365
		• 2 pieces: 2	lb-ft Nm	lb-ft Nm	lb-ft Nm	lb-ft Nm
SAE A	splined - 9 teeth	;	80 109	-	-	-
		2	-	-	-	-
SAE A	keyed	;	62 84	-	-	-
		2	-	-	-	-
SAE B	splined - 13 teeth	;	242 328	242 328	242 328	242 328
		2	-	159 215	242 328	242 328
SAE B	keyed	;	167 226	167 226	167 226	167 226
		2	-	159 215	167 226	167 226
SAE BB	splined - 15 teeth	;	-	371 503	371 503	371 503
		2	-	159 215	300 407	371 503
SAE BB	keyed	;	-	250 339	250 339	250 339
		2	-	159 215	250 339	250 339
SAE C	splined - 14 teeth	;	-	-	708 960	708 960
		2	-	159 215	300 407	533 723
SAE C	keyed	;	-	-	500 678	500 678
		2	-	159 215	300 407	500 678
DIN 5462 B8 x 32 x		2	-	159 215	300 407	-
DIN 254 taper 1:5		;	55 74	-	-	-
Connecting Shaft			90 122	159 215	300 407	533 723

## British Standard Pipe Parallel (BSPP)

BSPP	A	B	C	D
	mm	mm	mm	mm
0,50"-14	19,00	34,0	2,5	14,0
0,75"-14	24,50	40,0	2,5	16,0
1,00"-11	30,75	50,0	2,5	18,0
1,25"-11	39,50	58,0	2,5	20,0
1,50"-11	45,25	64,0	2,5	22,0
2,00"-11	56,25	78,0	3,0	24,0

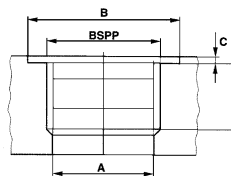

## SAE Straight Thread (ODT)

ODT	A	B	C	D	E
	UNF	mm	mm	mm	mm
1/2"	3/4"-16	14,3	30,2	2,4	2,55
5/8"	7/8"-14	16,7	34,1	2,4	2,55
3/4"	1 1/16"-12	19,1	41,3	2,4	3,30
7/8"	1 3/16"-12	19,1	44,8	2,4	3,30
1"	1 5/16"-12	19,1	48,5	2,4	3,30
1 1/4"	1 7/8"-12	19,1	57,7	2,4	3,35
1 1/2"	1 7/8"-12	19,1	65,0	2,4	3,35
2"	2 1/2"-12	19,1	88,4	2,4	3,35

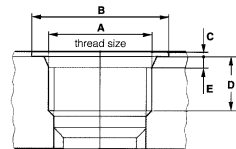



# Performance Curves P 315 - 330 - 350 - 365

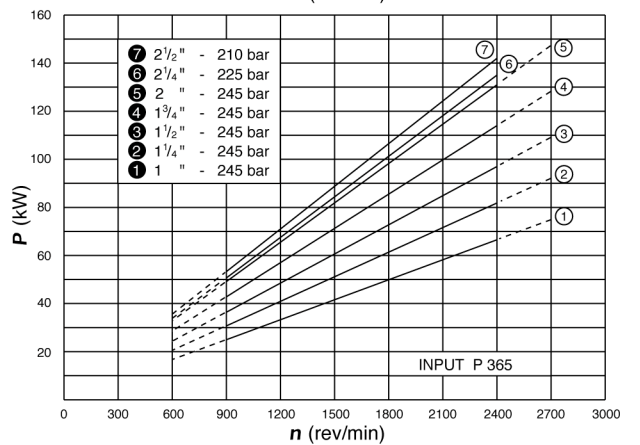
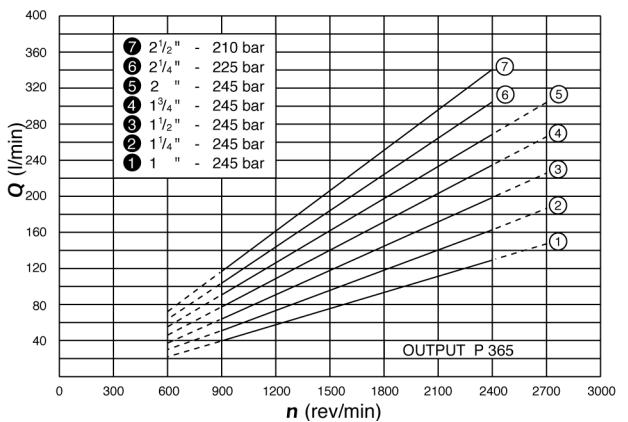
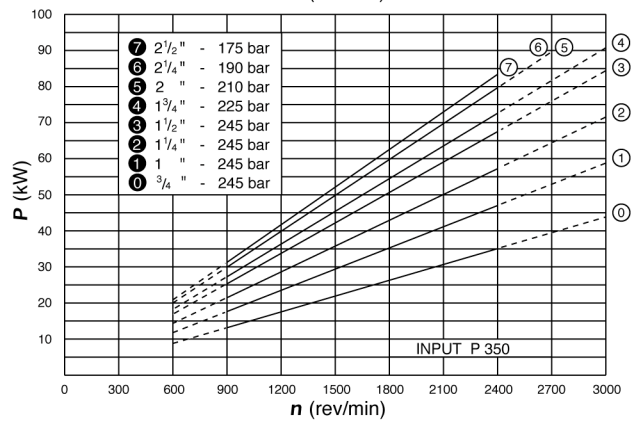
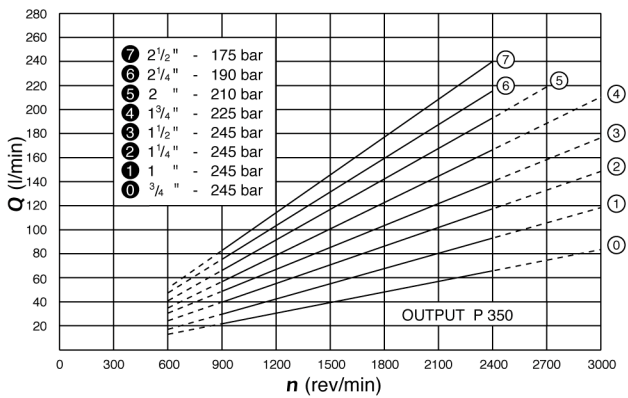
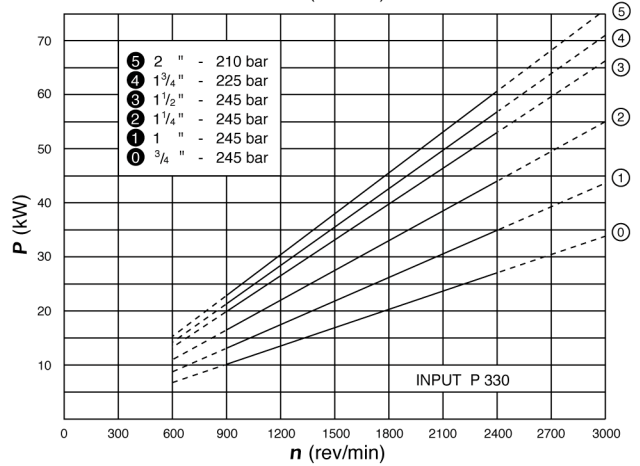
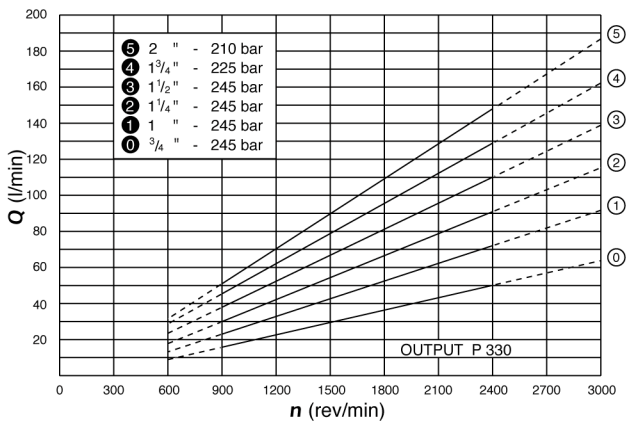
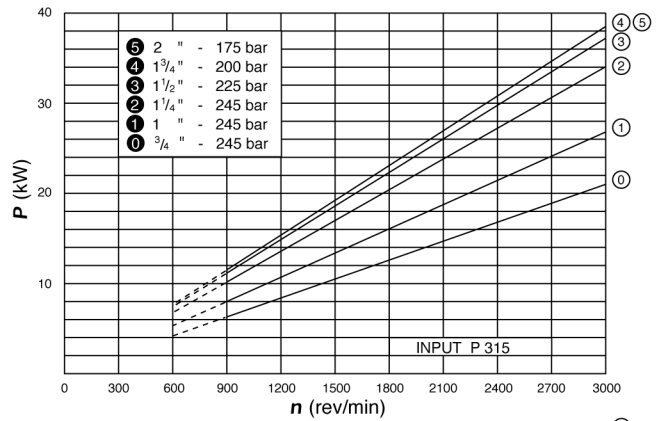
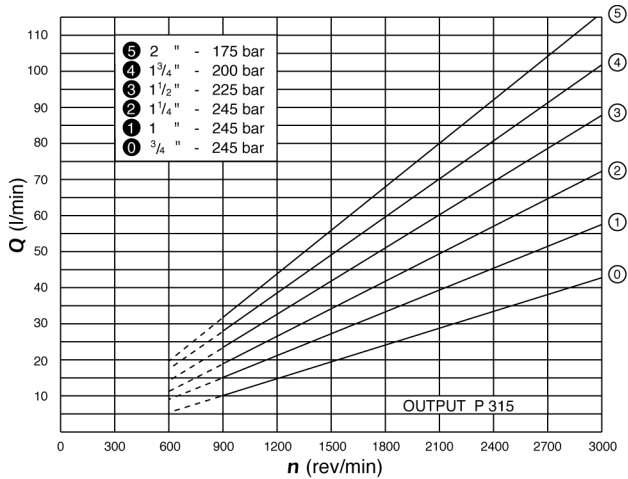

# Dimensional Data

## Single Pumps & Motors

Model	Dimensions Inches/mm									
	A	B	C**	D*	E	F	G	H	J(P)	J(M)
315	4.27+GW	4.75	4.25	1.62	1.88	2.00	.75	3.27+GW	4.0	4.19
	108.5+GW	120.7	108.0	41.1	47.8	50.8	19.1	83.1+GW	101.6	106.4
330	6.19+GW	5.88	6.88	1.62	3.12	2.56	.88	4.94+GW	4.81	5.00
	157.2+GW	149.4	174.8	41.1	79.2	65.0	22.2	125.5+GW	122.2	127.0
350	7.06+GW	6.00	7.12	2.19	3.50	3.06	1.00	5.56+GW	5.75	5.75
	179.3+GW	152.4	108.8	55.6	88.9	77.7	25.4	141.2+GW	146.1	146.1
365	7.31+GW	7.25	7.38	2.19	3.75	3.06	1.12	5.81+GW	6.25	6.25
	185.7+GW	184.2	187.5	55.6	95.3	77.7	28.6	147.6+GW	158.8	158.8

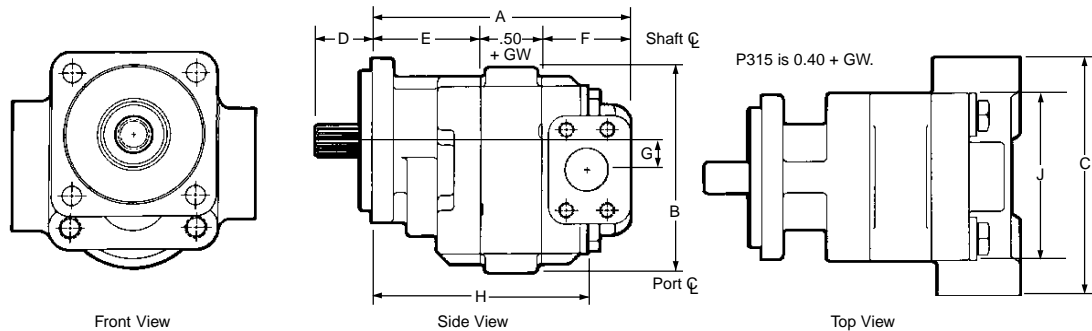

## Tandem Pumps & Motors

Model	Dimensions Inches/mm														
	A	B	C**	D*	E	F	G	H	I	J	K	L**	M**	N(P)	N(M)
315	7.05+T.GW	4.75	5.00	1.62	1.88	1.75	2.62	1.84	.34	.75	3.59+GW	2.25	2.75	4.0	4.19
	179.1+T.GW	120.7	127.0	41.1	47.8	44.5	66.5	46.7	8.6	19.1	91.2+GW	57.2	69.9	101.6	106.4
330	9.88+T.GW	5.88	6.78	1.62	3.12	2.25	3.50	2.38	.62	.88	5.38+GW	3.09	3.69	4.81	5.00
	250.9+T.GW	149.4	172.2	41.1	79.2	57.2	88.9	60.5	15.7	22.2	136.7+GW	78.5	93.7	122.2	127.0
350	10.25+T.GW	6.00	7.69	2.19	3.50	2.25	3.50	2.50	.50	1.00	5.75+GW	3.56	4.12	5.75	5.75
	260.4+T.GW	152.4	195.3	55.6	88.9	57.2	88.9	63.5	12.7	25.4	146.1+GW	90.4	104.6	146.1	146.1
365	11.38+T.GW	7.25	8.38	2.19	3.75	2.62	4.00	2.88	.62	1.12	6.25+GW	3.69	4.69	6.25	6.25
	289.1+T.GW	184.2	212.9	55.6	95.3	66.5	101.6	73.3	15.7	28.6	158.8+GW	93.7	119.1	158.8	158.8

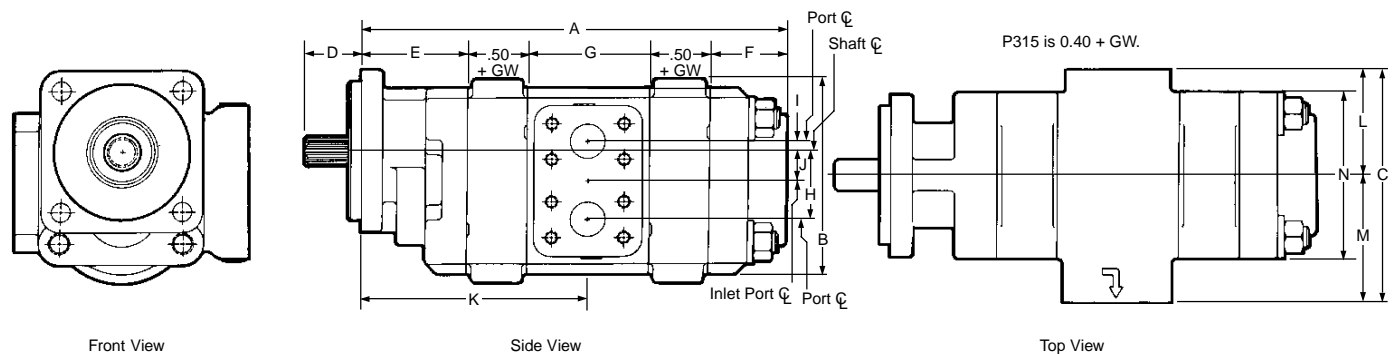

\* This dimension will vary with type of drive shaft. \*\* This dimension will vary with type of ports. T=Total.

## Weights

The following are the approximate weights of a single 1" gear section in each frame size:

P315 ..... 18 lbs.      P330 ..... 36 lbs.

P350 ..... 51 lbs.      P365 ..... 56 lbs.

For each additional 1/4" of gear width add:

P315 ..... 1 lb.      P330 ..... 1 1/4 lbs.

P350 .... 1 1/2 lbs.      P365 ..... 2 1/2 lbs.

To find the approximate weight of a multiple section assembly, add the weight of each section as a single. For the 330 frame size subtract 10% from this figure.

# 315 Pump Performance Data

speed rpm	output flow input power	Gear Widths						
		1/2"	3/4"	1"	1 1/4"	1 1/2"	1 3/4"	2"
900	GPM	2.0	3.2	4.4	5.5	6.7	7.9	9.0
	LPM	8	12	17	21	26	30	34
	HP	5	8	11	13	15	15	15
	kW	4	6	8	10	11	11	11
1200	GPM	2.8	4.4	6.0	7.6	9.2	10.7	12.2
	LPM	11	17	23	29	35	40	46
	HP	7	11	14	18	20	21	20
	kW	5	8	11	13	15	15	15
1500	GPM	3.6	5.6	7.7	9.6	11.6	13.5	15.4
	LPM	14	21	29	36	44	51	58
	HP	9	13	18	22	25	26	25
	kW	7	10	13	16	19	19	19
1800	GPM	4.4	6.8	9.3	11.6	14.0	16.3	18.6
	LPM	17	26	35	44	53	62	70
	HP	11	16	21	27	30	31	30
	kW	8	12	16	20	22	23	23
2100	GPM	5.2	8.1	10.9	13.6	16.4	19.1	21.8
	LPM	20	30	41	51	62	72	83
	HP	12	19	25	31	35	36	35
	kW	9	14	18	23	26	27	26
2400	GPM	6.0	9.3	12.5	15.6	18.8	21.9	25.1
	LPM	23	35	47	59	71	83	95
	HP	14	21	28	35	40	41	40
	kW	11	16	21	26	30	31	30
3000	GPM	7.7	11.7	15.7	19.6	23.7	27.6	31.5
	LPM	29	44	59	74	90	104	119
	HP	18	27	35	44	50	51	51
	kW	13	20	26	33	37	38	38

Performance data shown are the average results based on a series of laboratory tests of production units and are not necessarily representative of any one unit. Tests were run with the oil reservoir temperature at 120°F and viscosity 150 SUS at 100°F.

Note: Pump output flow is at the maximum rated pressure (see page 13).

# 315 Motor Performance Data

Speed RPM	Gear Widths									
	1"		1 1/4"		1 1/2"		1 3/4"		2"	
	3500 psi		3500 psi		3300 psi		2900 psi		2500 psi	
	A	B	A	B	A	B	A	B	A	B
900	7.1	665	8.3	830	9.6	940	10.9	965	12.2	950
	27	75.1	32	93.8	37	106.2	41	109.0	46	107.3
1200	8.8	665	10.5	830	12.2	940	13.8	965	15.5	950
	33	75.1	40	93.8	46	106.2	52	109.0	59	107.3
1500	10.6	660	12.6	825	14.7	935	16.7	955	18.8	945
	40	74.6	48	93.2	56	105.6	63	107.9	71	106.8
1800	12.3	655	14.7	820	17.2	930	19.6	950	22.1	940
	46	74.0	56	92.6	65	105.1	74	107.3	84	106.2
2100	14.0	655	16.8	820	19.7	930	22.5	950	25.4	940
	53	74.0	64	92.6	75	105.1	85	107.3	96	106.2
2400	15.7	640	18.9	800	22.2	910	25.4	930	28.8	920
	59	72.3	72	90.4	84	102.8	96	105.1	109	103.9
3000	19.0	640	23.0	800	27.2	905	31.2	925	35.3	915
	72	72.3	87	90.4	103	102.3	118	104.5	134	103.4

A: Input Flow GPM/LPM; B: Output Torque IN/LBS/Nm

Note: In accordance with our policy of continuing product development, we reserve the right to change specifications shown in this catalog without notice.



# 330 Pump Performance Data

speed rpm	output flow input power	Gear Widths						
		1/2"	3/4"	1"	1 1/4"	1 1/2"	1 3/4"	2"
900	GPM	3.2	5.1	7.0	8.8	10.6	12.4	14.3
	LPM	12	19	26	33	40	47	54
	HP	9	13	17	21	26	28	29
	kW	6	10	13	16	19	21	22
1200	GPM	4.5	7.0	9.5	12.0	14.5	16.9	19.4
	LPM	17	26	36	45	55	64	73
	HP	11	17	23	28	34	37	39
	kW	8	13	17	21	25	28	29
1500	GPM	5.8	8.9	12.1	15.2	18.3	21.4	24.5
	LPM	22	34	46	57	69	81	93
	HP	14	21	28	35	43	46	49
	kW	11	16	21	26	32	34	36
1800	GPM	7.1	10.8	14.7	18.4	22.1	25.9	29.6
	LPM	27	41	55	70	84	98	112
	HP	17	26	34	43	51	55	58
	kW	13	19	25	32	38	41	44
2100	GPM	8.4	12.7	17.2	21.6	26.0	30.3	34.7
	LPM	32	48	65	82	98	115	131
	HP	20	30	40	50	60	65	68
	kW	15	22	30	37	44	48	51
2400	GPM	9.6	14.7	19.8	24.8	29.8	34.8	39.8
	LPM	36	55	75	94	113	132	151
	HP	23	34	45	57	68	74	78
	kW	17	25	34	42	51	55	58
3000	GPM	12.2	18.5	24.9	31.2	37.5	43.8	50.1
	LPM	46	70	94	118	142	166	190
	HP	28	43	57	71	85	92	97
	kW	21	32	42	53	64	69	73

Performance data shown are the average results based on a series of laboratory tests of production units and are not necessarily representative of any one unit. Tests were run with the oil reservoir temperature at 120°F and viscosity 150 SUS at 100°F.

Note: Pump output flow is at the maximum rated pressure (see page 14).

# 330 Motor Performance Data

Speed RPM	Gear Widths									
	1"		1 1/4"		1 1/2"		1 3/4"		2"	
	3500 psi		3500 psi		3500 psi		3250 psi		3000 psi	
	A	B	A	B	A	B	A	B	A	B
900	10.1	1010	12.3	1270	14.5	1530	16.7	1665	19.0	1770
	38	114.1	47	143.5	55	172.9	63	188.1	72	200.0
1200	12.8	1005	15.7	1265	18.6	1525	21.4	1660	24.3	1760
	49	113.6	59	142.9	70	172.3	81	187.6	92	198.9
1500	15.6	1000	19.1	1255	22.6	1515	26.1	1650	29.6	1750
	59	113.0	72	141.8	85	171.2	99	186.4	112	197.7
1800	18.4	995	22.5	1250	26.6	1505	30.8	1640	34.9	1740
	69	112.4	85	141.2	101	170.0	116	185.3	132	196.6
2100	21.1	990	25.9	1240	30.7	1495	35.4	1625	40.2	1720
	80	111.9	98	140.1	116	168.9	134	183.6	152	194.3
2400	23.9	985	29.3	1235	34.7	1480	40.1	1605	45.5	1695
	90	111.3	111	139.5	131	167.2	152	181.3	172	191.5
3000	29.2	980	35.9	1230	42.6	1475	49.3	1595	56.0	1685
	110	110.7	136	139.0	161	166.7	186	180.2	212	190.4

A: Input Flow GPM/LPM; B: Output Torque IN/LBS/Nm

Note: In accordance with our policy of continuing product development, we reserve the right to change specifications shown in this catalog without notice.

# 350 Pump Performance Data

speed rpm	output flow input power	Gear Widths								
		1/2"	3/4"	1"	1 1/4"	1 1/2"	1 3/4"	2"	2 1/4"	2 1/2"
900	GPM	4.0	6.4	8.8	11.2	13.7	16.1	18.6	21.0	23.4
	LPM	15	24	33	42	52	61	70	79	89
	HP	11	17	22	28	33	36	38	39	40
	kW	8	12	17	21	25	27	28	29	30
1200	GPM	5.6	8.8	12.1	15.4	18.7	21.9	25.2	28.4	31.7
	LPM	21	33	46	58	71	83	95	108	120
	HP	15	22	30	37	44	48	51	52	53
	kW	11	17	22	28	33	36	38	39	39
1500	GPM	7.3	11.3	15.5	19.5	23.6	27.7	31.8	35.9	40.0
	LPM	28	43	59	74	89	105	120	136	151
	HP	18	28	37	46	55	60	63	65	66
	kW	14	21	28	34	41	45	47	49	49
1800	GPM	8.9	13.8	18.8	23.6	28.6	33.5	38.4	43.3	48.3
	LPM	34	52	71	89	108	127	145	164	183
	HP	22	33	44	55	67	72	76	78	79
	kW	17	25	33	41	50	54	57	58	59
2100	GPM	10.6	16.3	22.1	27.8	33.6	39.3	45.1	50.8	56.6
	LPM	40	62	84	105	127	149	171	192	214
	HP	26	39	52	65	78	84	89	91	92
	kW	19	29	39	48	58	63	66	68	69
2400	GPM	12.2	18.8	25.4	31.9	38.5	45.1	51.7	58.2	64.8
	LPM	46	71	96	121	146	171	196	220	245
	HP	30	44	59	74	89	96	101	105	106
	kW	22	33	44	55	66	72	76	78	79

Performance data shown are the average results based on a series of laboratory tests of production units and are not necessarily representative of any one unit. Tests were run with the oil reservoir temperature at 120°F and viscosity 150 SUS at 100°F.

Note: Pump output flow is at the maximum rated pressure (see page 16).

# 350 Motor Performance Data

Speed RPM	Gear Widths													
	1"		1 1/4"		1 1/2"		1 3/4"		2"		2 1/4"		2 1/2"	
	3500 psi	3500 psi	3500 psi	3500 psi	3500 psi	3500 psi	3250 psi	3250 psi	3000 psi	3000 psi	2750 psi	2750 psi	2500 psi	2500 psi
	A	B	A	B	A	B	A	B	A	B	A	B	A	B
900	13.4	1320	16.0	1670	18.6	2025	21.2	2225	23.8	2350	26.4	2425	28.9	2450
	51	149.1	61	188.7	70	228.8	80	251.4	90	265.5	100	274.0	110	276.8
1200	16.9	1315	20.4	1660	23.8	2015	27.2	2215	30.6	2340	34.0	2410	37.4	2435
	64	148.6	77	187.6	90	227.7	103	250.3	116	264.4	129	272.3	142	275.1
1500	20.5	1300	24.7	1640	28.9	1990	33.2	2195	37.4	2315	41.7	2385	45.9	2410
	77	146.9	93	185.3	110	224.8	126	248.0	142	261.6	158	269.5	174	272.3
1800	24.0	1295	29.0	1635	34.1	1980	39.2	2180	44.2	2300	49.3	2375	54.4	2395
	91	146.3	110	184.7	129	223.7	148	246.3	167	259.9	187	268.3	206	270.6
2100	27.5	1285	33.4	1620	39.3	1965	45.2	2165	51.1	2285	57.0	2355	62.9	2380
	104	145.2	126	183.0	149	222.0	171	244.6	193	258.2	216	266.1	238	268.9
2400	31.0	1265	37.7	1600	44.4	1940	51.2	2135	57.9	2255	64.6	2325	71.3	2350
	117	142.9	143	180.8	168	219.2	194	241.2	219	254.8	245	262.7	270	265.5

A: Input Flow GPM/LPM; B: Output Torque IN/LBS/Nm

Note: In accordance with our policy of continuing product development, we reserve the right to change specifications shown in this catalog without notice.

# 365 Pump Performance Data

speed rpm	output input	Gear Widths							
		3/4"	1"	1 1/4"	1 1/2"	1 3/4"	2"	2 1/4"	2 1/2"
900	GPM	8.0	11.5	14.9	18.4	21.8	25.4	28.8	32.3
	LPM	30	44	57	70	83	96	109	122
	HP	24	31	39	47	55	63	66	67
	kW	18	23	29	35	41	47	49	50
1200	GPM	11.5	16.2	20.8	25.5	30.0	34.7	39.3	44.0
	LPM	44	61	79	96	114	131	149	166
	HP	31	42	52	63	73	84	88	90
	kW	23	31	39	47	55	63	65	67
1500	GPM	15.0	20.9	26.6	32.5	38.2	44.1	49.8	55.6
	LPM	57	79	101	123	145	167	188	211
	HP	39	52	66	79	92	105	110	112
	kW	29	39	49	59	68	78	82	84
1800	GPM	18.5	25.6	32.5	39.5	46.4	53.4	60.3	67.3
	LPM	70	97	123	149	176	202	228	255
	HP	47	63	79	94	110	126	131	135
	kW	35	47	59	70	82	94	98	101
2100	GPM	22.0	30.2	38.3	46.5	54.6	62.8	70.8	79.0
	LPM	83	114	145	176	207	238	268	299
	HP	55	73	92	110	128	147	153	157
	kW	41	55	68	82	96	110	114	117
2400	GPM	25.6	34.9	44.2	53.5	62.8	72.1	81.4	90.7
	LPM	97	132	167	203	238	273	308	343
	HP	63	84	105	126	147	168	175	180
	kW	47	63	78	94	110	125	131	134

Performance data shown are the average results based on a series of laboratory tests of production units and are not necessarily representative of any one unit. Tests were run with the oil reservoir temperature at 120°F and viscosity 150 SUS at 100°F.

Note: Pump output flow is at the maximum rated pressure (see page 18).

# 365 Motor Performance Data

Speed RPM	Gear Widths													
	1"		1 1/4"		1 1/2"		1 3/4"		2"		2 1/4"		2 1/2"	
	3500 psi		3500 psi		3500 psi		3500 psi		3500 psi		3250 psi		3000 psi	
	A	B	A	B	A	B	A	B	A	B	A	B	A	B
900	18.4	1865	22.0	2355	25.6	2860	29.2	3370	32.9	3850	36.5	4020	40.1	4125
	70	210.7	83	266.1	97	323.1	111	380.8	124	435.0	138	454.2	152	466.1
1200	23.3	1845	28.1	2330	32.9	2830	37.6	3335	42.4	3810	47.2	3980	52.0	4080
	88	208.5	106	263.3	124	319.7	142	376.8	160	430.5	179	449.7	197	461.0
1500	28.2	1815	34.1	2295	40.1	2780	46.0	3280	52.0	3750	57.9	3915	63.8	4020
	107	205.1	129	259.3	152	314.1	174	370.6	197	423.7	219	442.3	242	454.2
1800	33.1	1805	40.2	2280	47.3	2765	54.4	3265	61.5	3730	68.6	3895	75.7	3995
	125	203.9	152	257.6	179	312.4	206	368.9	233	421.4	260	440.1	287	451.4
2100	37.9	1755	46.2	2220	54.4	2690	62.8	3160	71.1	3610	79.3	3770	87.6	3865
	144	198.3	175	250.8	206	303.9	238	357.0	269	407.9	300	426.0	332	436.7
2400	42.8	1705	52.3	2155	61.7	2615	71.2	3055	80.6	3490	90.1	3645	99.5	3740
	162	192.6	198	243.5	234	295.5	269	345.2	305	394.3	341	411.8	377	422.6

A: Input Flow GPM/LPM; B: Output Torque IN/LBS/Nm

Note: In accordance with our policy of continuing product development, we reserve the right to change specifications shown in this catalog without notice.

# 315 Series Coding

Tandem: Repeat if Necessary

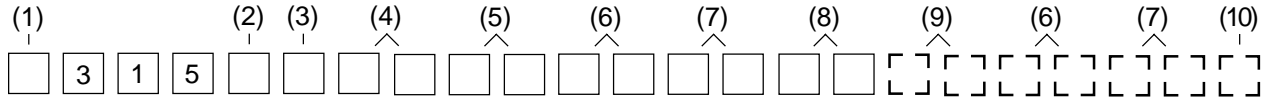

## Pump/Motor (1)

<b>P</b>	Pump
<b>M</b>	Motor (no tandem motors available)

## Unit (2)

<b>A</b>	Single Unit
<b>B</b>	Tandem Unit (flush studs)
<b>L</b>	Unit with Extended Studs

## Shaft End Cover (3)

<b>1</b>	Pump, cw w/o O.B. bearing
<b>2</b>	Pump, ccw w/o O.B. bearing
<b>4</b>	Pump, cw with O.B. bearing (Code 490 Only)
<b>5</b>	Pump, ccw with O.B. bearing (Code 590 Only)
<b>9</b>	Motor, bi-rot w/o O.B. bearing + 1/4" ODT drain

## Shaft End Cover (4)

<b>90</b>	4 bolt 72x100mm 80mm pilot
<b>93</b>	SAE "A" 2 bolt
<b>95</b>	Pad Mount for Clutch
<b>96</b>	SAE "B" 2 bolt

## Port End Cover (5) (Side Ported)

IN		OUT		CW		CCW	
IN	OUT	CW	CCW	IN	OUT	CW	CCW
<b>SAE Split Flange (pump)</b>							
1"	3/4"	EJ	JE				
1"	1/2"	EK	KE				
3/4"	3/4"	EL	LE				
3/4"	1/2"	EM	ME				
1"	-	OE	EO				
3/4"	-	OF	FO				
-	3/4"	OJ	JO				
-	1/2"	OL	LO				

## SAE Split Flange (motor)

1"	1"	DR-Double
3/4"	3/4"	DS-Double

## National Pipe Thread (pump)

1 1/4"	1"	AJ	JA
1 1/4"	3/4"	AK	KA
1"	1"	AL	LA
1"	3/4"	AM	MA
3/4"	3/4"	AR	RA

## National Pipe Thread (motor)

1"	1"	DM-Double
3/4"	3/4"	DN-Double
1/2"	1/2"	DQ-Double

## Unported (pump)

<b>BI</b>	Unported
-----------	----------

IN		OUT		CW		CCW	
IN	OUT	CW	CCW	IN	OUT	CW	CCW

## OD Tube Porting (pump)

1 1/4"	1"	FB	BF
1 1/4"	7/8"	FC	CF
1 1/4"	3/4"	FG	GF
1 1/4"	5/8"	FJ	JF
1"	1"	FL	LF
1"	7/8"	FV	VF
1"	3/4"	FW	WF
1"	5/8"	FX	XF
7/8"	7/8"	FY	YF
7/8"	3/4"	FZ	ZF
7/8"	5/8"	BC	CB
7/8"	1/2"	BG	GB
3/4"	3/4"	BJ	JB
3/4"	5/8"	BL	LB
3/4"	1/2"	BN	NB
1 1/4"	-	BV	VB
1"	-	BW	WB
7/8"	-	BX	XB
3/4"	-	BY	YB
-	1"	BZ	ZB
-	7/8"	PD	DP
-	3/4"	PE	EP
-	5/8"	PM	MP
-	1/2"	PN	NP

## OD Tube Porting (motor)

1"	1"	VN-Double
3/4"	3/4"	VR-Double
1/2"	1/2"	VQ-Double

## (Side Ported) continued

IN		OUT		CW		CCW	
IN	OUT	CW	CCW	IN	OUT	CW	CCW
<b>BSPP Porting (pump)</b>							
1 1/4"	1"	FN	NF				
1 1/4"	7/8"	FP	PF				
1 1/4"	3/4"	FR	RF				
1"	1"	FS	SF				
1"	7/8"	FT	TF				
1"	3/4"	BP	PB				
7/8"	7/8"	BQ	QB				
7/8"	3/4"	BR	RB				
7/8"	1/2"	BT	TB				
3/4"	3/4"	BU	UB				
3/4"	1/2"	PQ	QP				
1 1/4"	-	PR	RP				
1"	-	PS	SP				
7/8"	-	PT	TP				
3/4"	-	PV	VP				
-	1"	PW	WP				
-	7/8"	PX	XP				
-	3/4"	PY	YP				
-	1/2"	PZ	ZP				

## (Rear Ported)

IN		OUT		CW		CCW	
IN	OUT	CW	CCW	IN	OUT	CW	CCW
<b>OD Tube Porting (pump)</b>							
1 1/4"	1"	UC	CU				
1 1/4"	7/8"	UF	FU				
1 1/4"	3/4"	UN	NU				
1"	1"	UD	DU				
1"	7/8"	UP	PU				
1"	3/4"	UQ	QU				
1"	5/8"	UR	RU				
7/8"	7/8"	LN	NL				
7/8"	3/4"	LP	PL				
7/8"	5/8"	LQ	QL				
3/4"	3/4"	LR	RL				
3/4"	5/8"	LS	SL				
3/4"	1/2"	LT	TL				

## OD Tube Porting (motor)

1"	1"	RN-Double
3/4"	3/4"	RQ-Double
1/2"	1/2"	RS-Double

## Gear Housing (6)

<b>AB</b>	Pump
<b>EB</b>	Motor

IN		OUT		CW		CCW	
IN	OUT	CW	CCW	IN	OUT	CW	CCW
<b>BSPP Porting (motor)</b>							
1"	1"	VY-Double					
3/4"	3/4"	VZ-Double					
1/2"	1/2"	VV-Double					

## Metric Split Flange (pump)

1"	3/4"	EV	VE
1"	1/2"	EW	WE
3/4"	3/4"	EX	XE
3/4"	1/2"	EY	YE
1"	0"	OP	PO
3/4"	0"	OR	RO
0"	3/4"	OT	TO
0"	1/2"	OV	VO

## Metric Split Flange (motor)

1"	1"	DV-Double
3/4"	3/4"	DW-Double

### Gear Width (7)

	Gear Width	in. <sup>3</sup> /rev.	cm <sup>3</sup> /rev.	Max Pressure
03	3/8"	.47	7.6	3500psi (241 bar)
05	1/2"	.62	10.2	3500psi (241 bar)
06	5/8"	.78	12.7	3500psi (241 bar)
07	3/4"	.93	15.2	3500psi (241 bar)
08	7/8"	1.09	17.8	3500psi (241 bar)
10	1"	1.24	20.3	3500psi (241 bar)
11	1 1/8"	1.40	22.9	3500psi (241 bar)
12	1 1/4"	1.55	25.4	3500psi (241 bar)
13	1 3/8"	1.71	27.9	3500psi (241 bar)
15	1 1/2"	1.86	30.5	3300psi (228 bar)
16	1 5/8"	2.02	33.0	3100psi (214 bar)
17	1 3/4"	2.17	35.6	2900psi (200 bar)
18	1 7/8"	2.33	38.1	2700psi (186 bar)
20	2"	2.48	40.6	2500psi (172 bar)

### Shaft Type (8)

(For Single or Tandem Units -unless noted)

97	SAE "A" Keyed
96	SAE "A" Splined
66	SAE "B" Keyed
65	SAE "B" Splined
60	Tapered, M12 x 1.5 thd. 3x5 mm Keyed; 1:5 taper (90 SEC Only)
56	Clutch Pump Tapered, 5/16 - 24 thd. (internal), #6 Woodruff Keyed (single unit only); 1:4 taper

### Bearing Carriers (9)

#### (Dual Outlet - Pump Only)

Outlets: for clockwise porting the top port number comes first; for counter-clockwise porting the bottom port number comes first.

IN	OUT	CW	CCW	IN	OUT	CW	CCW					
<b>SAE Split Flange</b>												
1 1/4"	3/4"	3/4"	CA	AC	1"	3/4"	3/4"	TC	CT			
1 1/4"	3/4"	1/2"	DA	AD	1"	3/4"	5/8"	VC	CV			
1 1/4"	1/2"	1/2"	EA	AE	1"	3/4"	1/2"	WC	CW			
1"	3/4"	3/4"	FA	AF	1"	5/8"	5/8"	XC	CX			
1"	3/4"	1/2"	GA	AG	1"	1/2"	1/2"	YC	CY			
1"	1/2"	1/2"	HA	AH	<b>Metric Split Flange</b>							
<b>OD Tube Porting</b>												
1 1/2"	1"	1"	JG	GJ	1 1/4"	3/4"	3/4"	BD	DB			
1 1/2"	1"	7/8"	KG	GK	1 1/4"	3/4"	1/2"	CD	DC			
1 1/2"	7/8"	7/8"	LG	GL	1 1/4"	1/2"	1/2"	ED	DE			
1 1/2"	1"	3/4"	MG	GM	1"	3/4"	3/4"	FD	DF			
1 1/2"	3/4"	3/4"	NG	GN	1"	3/4"	1/2"	GD	DG			
1 1/4"	1"	1"	PG	GP	1"	1/2"	1/2"	HD	DH			
1 1/4"	1"	7/8"	QG	GQ	<b>BSPP Porting</b>							
1 1/4"	7/8"	7/8"	RG	GR	1 1/2"	1"	1"	HJ	JH			
1 1/4"	1"	3/4"	SG	GS	1 1/2"	1"	7/8"	KJ	JK			
1 1/4"	3/4"	3/4"	TG	GT	1 1/2"	7/8"	7/8"	LJ	JL			
1 1/4"	3/4"	5/8"	UG	GU	1 1/2"	1"	3/4"	MJ	JM			
1 1/4"	3/4"	1/2"	VG	GV	1 1/2"	3/4"	3/4"	NJ	JN			
1 1/4"	5/8"	5/8"	WG	GW	1 1/4"	1"	1"	PJ	JP			
1 1/4"	1/2"	1/2"	XG	GX	1 1/4"	1"	7/8"	QJ	JQ			
1"	1"	1"	YG	GY	1 1/4"	7/8"	7/8"	RJ	JR			
1"	1"	7/8"	ZG	GZ	1 1/4"	1"	3/4"	SJ	JS			
1"	7/8"	7/8"	RC	CR	1 1/4"	3/4"	3/4"	TJ	JT			
1"	1"	3/4"	SC	CS	1 1/4"	3/4"	1/2"	UJ	JU			

### (Dual Outlet) continued

IN	OUT	CW	CCW	
1 1/4"	1/2"	1/2"	VJ	JV
1"	1"	1"	WJ	JW
1"	1"	7/8"	XJ	JX
1"	7/8"	7/8"	YJ	JY
1"	1"	3/4"	ZJ	JZ
1"	3/4"	3/4"	JD	DJ
1"	3/4"	1/2"	KD	DK
1"	1/2"	1/2"	LD	DL

### (Single Outlet - Pump Only)

Outlet for front section.

IN	OUT	CW	CCW	IN	OUT	CW	CCW
<b>SAE Split Flange</b>				<b>Metric Split Flange</b>			
1 1/4"	1 1/4"	CJ	JC	1 1/4"	1 1/4"	CN	NC
1 1/4"	1"	CL	LC	1 1/4"	1"	CP	PC
1 1/4"	3/4"	CM	MC	1 1/4"	3/4"	CQ	QC
1 1/4"	1/2"	HB	BH	1 1/4"	1/2"	HR	RH
1"	1"	HC	CH	1"	1"	HS	SH
1"	3/4"	HF	FH	1"	3/4"	HT	TH
1"	1/2"	HL	LH	1"	1/2"	HU	UH
3/4"	3/4"	HM	MH	3/4"	3/4"	HV	VH
3/4"	1/2"	HN	NH	3/4"	1/2"	HW	WH

### OD Tube Porting

1 1/2"	1 1/2"	KB	BK
1 1/2"	1 1/4"	KC	CK
1 1/2"	1"	KF	FK
1 1/2"	7/8"	KL	LK
1 1/2"	3/4"	KM	MK
1 1/4"	1 1/4"	KN	NK
1 1/4"	1"	KO	OK
1 1/4"	7/8"	KP	PK
1 1/4"	3/4"	KQ	QK
1 1/4"	5/8"	MB	BM
1 1/4"	1/2"	ML	LM
1"	1"	MN	NM
1"	7/8"	MQ	QM
1"	3/4"	MR	RM
1"	5/8"	MS	SM
1"	1/2"	MT	TM
3/4"	3/4"	MU	UM
3/4"	5/8"	MV	VM
3/4"	1/2"	MW	WM

### BSPP Porting

1 1/2"	1 1/2"	KR	RK
1 1/2"	1 1/4"	KS	SK
1 1/2"	1"	KT	TK
1 1/2"	7/8"	KU	UK
1 1/2"	3/4"	KV	VK
1 1/4"	1 1/4"	KW	WK
1 1/4"	1"	KX	XK
1 1/4"	7/8"	KY	YK
1 1/4"	3/4"	KZ	ZK
1 1/4"	1/2"	HO	OH
1"	1"	HP	PH
1"	7/8"	HQ	QH
1"	3/4"	HX	XH
1"	1/2"	HY	YH
3/4"	3/4"	HZ	ZH
3/4"	1/2"	MX	XM

### Common Inlet Passage

No Ports	C	D
----------	---	---

### Connecting Shaft (10)

For connecting tandem units.

1 Connecting Shaft

# 330 Series Coding

Tandem: Repeat if Necessary

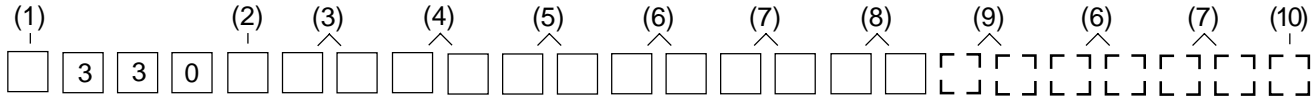

## Pump/Motor (1)

<b>P</b>	Pump
<b>M</b>	Motor

## Unit (2)

<b>A</b>	Single Unit
<b>B</b>	Tandem Unit (flush studs)
<b>C</b>	Single or Tandem w. two-piece shaft (O.B. bearing required)
<b>L</b>	Unit with Extended Studs

## Shaft End Cover (3)

<b>1</b>	Pump, cw w/o O.B. bearing
<b>2</b>	Pump, ccw w/o O.B. bearing
<b>4</b>	Pump, cw with O.B. bearing
<b>5</b>	Pump, ccw with O.B. bearing
<b>8</b>	Motor, bi-rot w/ O.B. bearing + 1/4" ODT drain
<b>9</b>	Motor, bi-rot w/o O.B. bearing + 1/4" ODT drain
<b>18</b>	Motor, bi-rot w/ O.B. bearing + 1/4" BSPP drain (78 only)
<b>19</b>	Motor, bi-rot w/o O.B. bearing + 1/4" BSPP drain (42 & 78 only)

## Shaft End Cover (4)

<b>42</b>	SAE 4 bolt "B"
<b>78</b>	SAE 4 bolt "C"
<b>97</b>	SAE 2 bolt "B"

## Port End Cover (5) (Side Ported)

IN	OUT	CW	CCW	IN	OUT	CW	CCW
<b>SAE Split Flange (pump)</b>				<b>OD Tube Porting (motor)</b>			
1 1/2"	1 1/4"	<b>EJ</b>	<b>JE</b>	1 1/4"	1 1/4"	<b>VC</b> -Double	
1 1/2"	1"	<b>EK</b>	<b>KE</b>	1"	1"	<b>VN</b> -Double	
1 1/4"	1 1/4"	<b>EL</b>	<b>LE</b>	3/4"	3/4"	<b>VR</b> -Double	
1 1/4"	1"	<b>EM</b>	<b>ME</b>				
1"	1"	<b>EN</b>	<b>NE</b>				
1 1/2"	-	<b>OF</b>	<b>FO</b>				
1 1/4"	-	<b>OG</b>	<b>GO</b>				
1"	-	<b>OJ</b>	<b>JO</b>				
-	1 1/4"	<b>OM</b>	<b>MO</b>				
-	1"	<b>ON</b>	<b>NO</b>				

## SAE Split Flange (motor)

1 1/4"	1 1/4"	<b>CS</b> -Double
1"	1"	<b>CT</b> -Double
3/4"	3/4"	<b>CV</b> -Double

## OD Tube Porting (pump)

1 1/4"	1"	<b>FJ</b>	<b>JF</b>
1"	1"	<b>FL</b>	<b>LF</b>
1 1/4"	-	<b>BG</b>	<b>GB</b>
1"	-	<b>BJ</b>	<b>JB</b>
-	1"	<b>BN</b>	<b>NB</b>

## (Side Ported) continued

IN	OUT	CW	CCW	IN	OUT	CW	CCW
<b>Metric Split Flange (motor)</b>				<b>BSPP Porting (pump)</b>			
1 1/4"	1 1/4"	<b>CX</b> -Double		1 1/4"	1"	<b>FS</b>	<b>SF</b>
1"	1"	<b>CY</b> -Double		1"	1"	<b>FT</b>	<b>TF</b>
3/4"	3/4"	<b>CZ</b> -Double		1 1/4"	-	<b>BQ</b>	<b>QB</b>
				1"	-	<b>BR</b>	<b>RB</b>
				-	1"	<b>BU</b>	<b>UB</b>
<b>Metric Straight Thread (motor)</b>				<b>BSPP Porting (motor)</b>			
1 1/4"	1 1/4"	<b>VS</b> -Double		1 1/4"	1 1/4"	<b>VX</b> -Double	
1"	1"	<b>VT</b> -Double		1"	1"	<b>VY</b> -Double	
3/4"	3/4"	<b>VW</b> -Double		3/4"	3/4"	<b>VZ</b> -Double	

## Gear Housing (6)

<b>AB</b>	Pump
<b>EB</b>	Motor

## Gear Width (7)

	Gear Width	in. <sup>3</sup> /rev.	cm <sup>3</sup> /rev.	Max Pressure
<b>05</b>	1/2"	.99	16.1	3500psi (241 bar)
<b>07</b>	3/4"	1.48	24.2	3500psi (241 bar)
<b>10</b>	1"	1.97	32.3	3500psi (241 bar)
<b>12</b>	1 1/4"	2.46	40.4	3500psi (241 bar)
<b>15</b>	1 1/2"	2.96	48.4	3500psi (241 bar)
<b>17</b>	1 3/4"	3.45	56.5	3250psi (224 bar)
<b>20</b>	2"	3.94	64.6	3000psi (207 bar)

## Shaft Type (8)

(For Single, Tandem or Two-piece Shaft -unless noted)

<b>07</b>	SAE "C" Spline (two-piece only)
<b>25</b>	SAE "B" Spline
<b>30</b>	SAE "B" Keyed
<b>98</b>	SAE "BB" Splined
<b>43</b>	SAE "BB" Keyed

## Unported (pump)

<b>BI</b>	Unported
-----------	----------

## Unported (motor)

<b>BA</b>	Unported
-----------	----------

### Bearing Carriers (9) (Dual Outlet - Pump Only)

Outlets: for clockwise porting the top port number comes first;  
for counter-clockwise porting the bottom port number comes first.

IN	OUT	CW	CCW		
	^				
<b>SAE Split Flange</b>					
2"	1 1/4"	1 1/4"	AM	MA	
2"	1 1/4"	1"	AN	NA	
2"	1"	1"	AP	PA	
1 1/2"	1 1/4"	1 1/4"	AT	TA	
1 1/2"	1 1/4"	1"	AU	UA	
1 1/2"	1"	1"	AV	VA	
1 1/4"	1 1/4"	1 1/4"	AW	WA	
1 1/4"	1 1/4"	1"	AX	XA	
1 1/4"	1"	1"	AY	YA	
1"	1"	1"	AZ	ZA	

#### Metric Split Flange

2"	1 1/4"	1 1/4"	DM	MD
2"	1 1/4"	1"	DN	ND
2"	1"	1"	DP	PD
1 1/2"	1 1/4"	1 1/4"	DT	TD
1 1/2"	1 1/4"	1"	DU	UD
1 1/2"	1"	1"	DV	VD
1 1/4"	1 1/4"	1 1/4"	DW	WD
1 1/4"	1 1/4"	1"	DX	XD
1"	1"	1"	DZ	ZD

### (Single Outlet - Pump Only)

Outlet is for front section.

IN	OUT	CW	CCW		
<b>SAE Split Flange</b>					
2"	1 1/2"		HB	BH	
2"	1 1/4"		HC	CH	
2"	1"		HF	FH	
1 1/2"	1 1/2"		HL	LH	
1 1/2"	1 1/4"		HM	MH	
1 1/2"	1"		HN	NH	
1 1/4"	1 1/4"		HO	OH	
1 1/4"	1"		HP	PH	
1"	1"		HQ	QH	
* 1 1/4"	1"		RS	SR	

#### OD Tube Porting

1 1/2"	1 1/4"	-	KM	MK
1 1/2"	1"	-	KN	NK
1 1/4"	1 1/4"	-	KO	OK
1 1/4"	1"	-	KP	PK
1"	1"	-	KQ	QK

\* Outlet port for rear section.

### (Combined Outlet)

IN	OUT	CW	CCW		
<b>SAE Split Flange (pump)</b>					
2"	1 1/2"		UN	NU	
2"	1 1/4"		UO	OU	
1 1/2"	1 1/2"		UP	PU	
1 1/2"	1 1/4"		UQ	QU	
1 1/4"	1 1/4"		UR	RU	

#### SAE Split Flange (motor)

1 1/2"	1 1/2"		BB	Double
1 1/4"	1 1/4"		CC	Double
1"	1"		EE	Double
3/4"	3/4"		FF	Double

#### OD Tube Porting (pump)

1 1/2"	1 1/4"		PQ	QP
1 1/4"	1 1/4"		PR	RP

#### OD Tube Porting (motor)

1 1/4"	1 1/4"		NN	Double
1"	1"		QQ	Double
3/4"	3/4"		RR	Double

#### Common Inlet Passage (pump)

No Ports		C	D
----------	--	---	---

IN	OUT		
<b>Metric Split Flange (motor)</b>			
1 1/2"	1 1/2"		HH-Double
1 1/4"	1 1/4"		JJ-Double
1"	1"		KK-Double
3/4"	3/4"		LL-Double

#### BSPP Porting (motor)

1 1/4"	1 1/4"		XX-Double
1"	1"		YY-Double
3/4"	3/4"		ZZ-Double

#### Metric Straight Thread (motor)

1 1/4"	1 1/4"		TT-Double
1"	1"		UU-Double
3/4"	3/4"		VV-Double

### Connecting Shaft (10)

For connecting tandem units.

1 Connecting Shaft



# 350 Series Coding

Tandem: Repeat if Necessary

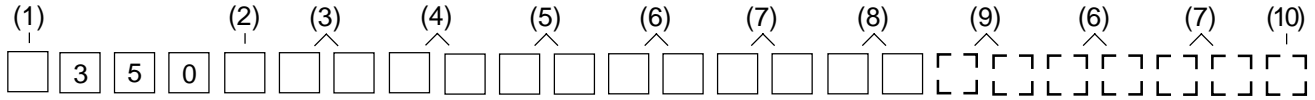

## Pump/Motor (1)

P	Pump
M	Motor

## Unit (2)

A	Single Unit
B	Tandem Unit (flush studs)
C	Single or Tandem w. two-piece shaft (O.B. bearing required)
L	Unit with Extended Studs

## Shaft End Cover (3)

1	Pump, cw w/o O.B. bearing
2	Pump, ccw w/o O.B. bearing
4	Pump, cw with O.B. bearing
5	Pump, ccw with O.B. bearing
8	Motor, bi-rot w/ O.B. bearing + 1/4" ODT drain
9	Motor, bi-rot w/o O.B. bearing + 1/4" ODT drain
18	Motor, bi-rot w/ O.B. bearing + 1/4" BSPP drain (78 Only)
19	Motor, bi-rot w/o O.B. bearing + 1/4" BSPP drain (78 Only)

## Shaft End Cover (4)

42	SAE 4 bolt "B"
46	SAE 2/4 bolt "B"
62	"ZF" 4 bolt (462 only) - 80 mm pilot, 80x80 mm
78	SAE 4 bolt "C"
97	SAE 2 bolt "B"
98	SAE 2 bolt "C"

## Port End Cover (5) (Side Ported)

IN	OUT	CW	CCW	IN	OUT	CW	CCW
<b>SAE Split Flange (pump)</b>				<b>OD Tube Porting (pump)</b>			
2"	1 1/2"	EC	CE	1 1/2"	1 1/4"	FB	BF
2"	1 1/4"	EF	FE	1 1/2"	1"	FC	CF
2"	1"	EG	GE	1 1/4"	1 1/4"	FG	GF
1 1/2"	1 1/2"	EH	HE	1 1/4"	1"	FJ	JF
1 1/2"	1 1/4"	EJ	JE	1"	1"	FL	LF
1 1/2"	1"	EK	KE	1 1/2"	-	BC	CB
1 1/4"	1 1/4"	EL	LE	1 1/4"	-	BG	GB
1 1/4"	1"	EM	ME	1"	-	BJ	JB
1"	1"	EN	NE	-	1 1/4"	BL	LB
2"	-	OE	EO	-	1"	BN	NB
1 1/2"	-	OF	FO	<b>OD Tube Porting (motor)</b>			
1 1/4"	-	OG	GO	1 1/4"	1 1/4"	VC	Double
1"	-	OJ	JO	1"	1"	VN	Double
-	1 1/2"	OL	LO	3/4"	3/4"	VR	Double
-	1 1/4"	OM	MO	<b>Unported (pump)</b>			
-	1"	ON	NO	Unported	BI	IB	

## SAE Split Flange (motor)

1 1/2"	1 1/2"	CR	Double
1 1/4"	1 1/4"	CS	Double
1"	1"	CT	Double
3/4"	3/4"	CV	Double

## (Side Ported) continued

IN	OUT	CW	CCW
<b>Metric Split Flange (pump)</b>			
2"	1 1/2"	ER	RE
2"	1 1/4"	ES	SE
2"	1"	ET	TE
1 1/2"	1 1/2"	EU	UE
1 1/2"	1 1/4"	EV	VE
1 1/2"	1"	EW	WE
1 1/4"	1 1/4"	EX	XE
1 1/4"	1"	EY	YE
1"	1"	EZ	ZE
2"	-	OP	PO
1 1/2"	-	OR	RO
1 1/4"	-	OS	SO
1"	-	OT	TO
-	1 1/2"	OV	VO
-	1 1/4"	OW	WO
-	1"	OX	XO

## Metric Split Flange (motor)

1 1/2"	1 1/2"	CW	Double
1 1/4"	1 1/4"	CX	Double
1"	1"	CY	Double
3/4"	3/4"	CZ	Double

IN	OUT	CW	CCW
----	-----	----	-----

## Metric Straight Thread (motor)

1 1/4"	1 1/4"	VS	Double
1"	1"	VT	Double
3/4"	3/4"	VW	Double

## BSPP Porting (pump)

1 1/2"	1 1/4"	FN	NF
1 1/2"	1"	FP	PF
1 1/4"	1 1/4"	FR	RF
1 1/4"	1"	FS	SF
1"	1"	FT	TF
1 1/2"	-	BP	PB
1 1/4"	-	BQ	QB
1"	-	BR	RB
-	1 1/4"	BT	TB
-	1"	BU	UB

## BSPP Porting (motor)

1 1/4"	1 1/4"	VX	Double
1"	1"	VY	Double
3/4"	3/4"	VZ	Double

## Gear Housing (6)

AB	Pump
EB	Motor

## Gear Width (7)

	Gear Width	in. <sup>3</sup> /rev.	cm <sup>3</sup> /rev.	Max Pressure
05	1/2"	1.28	20.9	3500psi (241 bar)
07	3/4"	1.91	31.3	3500psi (241 bar)
10	1"	2.55	41.8	3500psi (241 bar)
12	1 1/4"	3.19	52.2	3500psi (241 bar)
15	1 1/2"	3.83	62.7	3500psi (241 bar)
17	1 3/4"	4.46	73.1	3250psi (224 bar)
20	2"	5.10	83.6	3000psi (207 bar)
22	2 1/4"	5.74	94.0	2750psi (190 bar)
25	2 1/2"	6.38	104.5	2500psi (172 bar)

## Shaft Type (8)

(For Single, Tandem or Two-piece Shaft -unless noted)

06 88X32X36 DIN 5462 Spline (two-piece only)

07 SAE "C" Spline

11 SAE "C" Keyed

25 SAE "B" Spline

43 SAE "BB" Keyed

73 SAE "C" Keyed Long (single and two-piece only)

98 SAE "BB" Splined (tandem only)

## Bearing Carriers (9)

### (Dual Outlet - Pump Only)

Outlets: for clockwise porting the top port number comes first;  
for counter-clockwise porting the bottom port number comes first.

IN	OUT	CW	CCW	IN	OUT	CW	CCW
	^				^		
<b>SAE Split Flange</b>							
2 1/2"	1 1/4"	1 1/4"	AF FA	2"	1 1/4"	1 1/4"	GM MG
2 1/2"	1 1/4"	1"	AG GA	2"	1 1/4"	1"	GN NG
2 1/2"	1"	1"	AH HA	2"	1"	1"	GP PG
2"	1 1/4"	1 1/4"	AM MA	1 1/2"	1 1/4"	1 1/4"	GT TG
2"	1 1/4"	1"	AN NA	1 1/2"	1 1/4"	1"	GU UG
2"	1"	1"	AP PA	1 1/2"	1"	1"	GV VG
1 1/2"	1 1/4"	1 1/4"	AT TA	1 1/4"	1 1/4"	1 1/4"	GW WG
1 1/2"	1 1/4"	1"	AU UA	1 1/4"	1 1/4"	1"	GX XG
1 1/2"	1"	1"	AV VA	1 1/4"	1"	1"	GY YG
1 1/4"	1 1/4"	1 1/4"	AW WA	1"	1"	1"	GZ ZG
1 1/4"	1 1/4"	1"	AX XA				
1 1/4"	1"	1"	AY YA				
1"	1"	1"	AZ ZA				

### Metric Split Flange

2"	1 1/4"	1 1/4"	DM MD
2"	1 1/4"	1"	DN ND
2"	1"	1"	DP PD
1 1/2"	1 1/4"	1 1/4"	DT TD
1 1/2"	1 1/4"	1"	DU UD
1 1/2"	1"	1"	DV VD
1 1/4"	1 1/4"	1 1/4"	DW WD
1 1/4"	1 1/4"	1"	DX XD
1 1/4"	1"	1"	DY YD
1"	1"	1"	DZ ZD

### (Single Outlet - Pump Only) Outlet for front section.

IN	OUT	CW	CCW	IN	OUT	CW	CCW
<b>SAE Split Flange</b>							
2"	1 1/2"		HB BH	2"	1 1/2"		KB BK
2"	1 1/4"		HC CH	2"	1 1/4"		KC CK
2"	1"		HF FH	2"	1"		KF FK
1 1/2"	1 1/2"		HL LH	1 1/2"	1 1/2"		KL LK
1 1/2"	1 1/4"		HM MH	1 1/2"	1 1/4"		KM MK
1 1/2"	1"		HN NH	1 1/2"	1"		KN NK
1 1/4"	1 1/4"		HO OH	1 1/4"	1 1/4"		KO OK
1 1/4"	1"		HP PH	1 1/4"	1"		KP PK
1"	1"		HQ QH	1"	1"		KQ QK
* 1 1/4"	1"		RS SR				

\* Outlet port for rear section.

## (Single Outlet)

IN	OUT	CW	CCW
<b>BSPP Porting</b>			
2"	1 1/2"	KR	RK
2"	1 1/4"	KS	SK
2"	1"	KT	TK
1 1/2"	1 1/2"	KU	UK
1 1/2"	1 1/4"	KV	VK
1 1/2"	1"	KW	WK
1 1/4"	1 1/4"	KX	XK
1 1/4"	1"	KY	YK
1"	1"	KZ	ZK

## (Combined Outlet)

IN	OUT	CW	CCW
<b>SAE Split Flange (pump)</b>			
2"	1 1/2"	UN	NU
2"	1 1/4"	UO	OU
1 1/2"	1 1/2"	UP	PU
1 1/2"	1 1/4"	UQ	QU
1 1/4"	1 1/4"	UR	RU

### SAE Split Flange (motor)

2"	2"	AA-Double
1 1/2"	1 1/2"	BB-Double
1 1/4"	1 1/4"	CC-Double
1"	1"	EE-Double
3/4"	3/4"	FF-Double

### OD Tube Porting (pump)

2"	1 1/2"	PE	EP
2"	1 1/4"	PM	MP
1 1/2"	1 1/2"	PN	NP
1 1/2"	1 1/4"	PQ	QP
1 1/4"	1 1/4"	PR	RP

### OD Tube Porting (motor)

1 1/2"	1 1/2"	MM-Double
1 1/4"	1 1/4"	NN-Double
1"	1"	QQ-Double
3/4"	3/4"	RR-Double

### Common Inlet Passage

No Ports C D

## Connecting Shaft (10)

For connecting tandem units.

1 Connecting Shaft

IN	OUT	
<b>Metric Split Flange (motor)</b>		
2"	2"	GG-Double
1 1/2"	1 1/2"	HH-Double
1 1/4"	1 1/4"	JJ-Double
1"	1"	KK-Double
3/4"	3/4"	LL-Double

### BSPP Porting (motor)

1 1/2"	1 1/2"	WW-Double
1 1/4"	1 1/4"	XX-Double
1"	1"	YY-Double
3/4"	3/4"	ZZ-Double

### Metric Straight Thread (motor)

1 1/2"	1 1/2"	SS-Double
1 1/4"	1 1/4"	TT-Double
1"	1"	UU-Double
3/4"	3/4"	VV-Double

# 365 Series Coding

Tandem: Repeat if Necessary

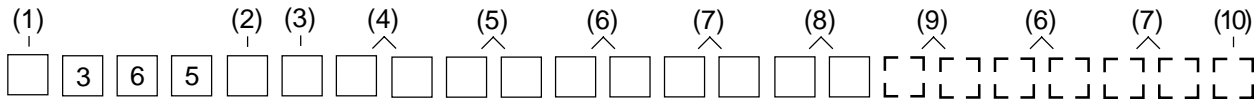

## Pump/Motor (1)

<b>P</b>	Pump
<b>M</b>	Motor

## Unit (2)

<b>A</b>	Single Unit
<b>B</b>	Tandem Unit (flush studs)
<b>C</b>	Single or Tandem w. two-piece shaft (O.B. bearing required)
<b>L</b>	Unit Extended Studs

## Shaft End Cover (3)

<b>1</b>	Pump, cw w/o O.B. bearing
<b>2</b>	Pump, ccw w/o O.B. bearing
<b>4</b>	Pump, cw with O.B. bearing
<b>5</b>	Pump, ccw with O.B. bearing
<b>8</b>	Motor, bi-rot w/ O.B. bearing + 1/4" ODT drain
<b>9</b>	Motor, bi-rot w/o O.B. bearing + 1/4" ODT drain

## Shaft End Cover (4)

<b>42</b>	SAE 4 bolt "B"
<b>78</b>	SAE 4 bolt "C"
<b>97</b>	SAE 2 bolt "B"
<b>98</b>	SAE 2 bolt "C"

## Port End Cover (5) (Side Ported)

IN	OUT	CW	CCW
<b>SAE Split Flange (pump)</b>			
2" 1 1/2"	EC	CE	
2" 1 1/4"	EF	FE	
2" 1"	EG	GE	
1 1/2" 1 1/2"	EH	HE	
1 1/2" 1 1/4"	EJ	JE	
1 1/2" 1"	EK	KE	
1 1/4" 1 1/4"	EL	LE	
1 1/4" 1"	EM	ME	
1" 1"	EN	NE	
2" -	OE	EO	
1 1/2" -	OF	FO	
1 1/4" -	OG	GO	
1" -	OJ	JO	
- 1 1/2"	OL	LO	
- 1 1/4"	OM	MO	
- 1"	ON	NO	

## SAE Split Flange (motor)

1 1/2" 1 1/2"	CR-Double
1 1/4" 1 1/4"	CS-Double
1" 1"	CT-Double
3/4" 3/4"	CV-Double

## (Side Ported) continued

IN	OUT	CW	CCW
<b>Metric Split Flange (pump)</b>			
2" 1 1/2"	ER	RE	
2" 1 1/4"	ES	SE	
2" 1"	ET	TE	
1 1/2" 1 1/2"	EU	UE	
1 1/2" 1 1/4"	EV	VE	
1 1/2" 1"	EW	WE	
1 1/4" 1 1/4"	EX	XE	
1 1/4" 1"	EY	YE	
1" 1"	EZ	ZE	
2" -	OP	PO	
1 1/2" -	OR	RO	
1 1/4" -	OS	SO	
1" -	OT	TO	
- 1 1/2"	OV	VO	
- 1 1/4"	OW	WO	
- 1"	OX	XO	

## Metric Split Flange (motor)

1 1/2" 1 1/2"	CW-Double
1 1/4" 1 1/4"	CX-Double
1" 1"	CY-Double
3/4" 3/4"	CZ-Double

IN	OUT	CW	CCW
<b>Metric Straight Thread (motor)</b>			
1 1/4" 1 1/4"	VS-Double		
1" 1"	VT-Double		
3/4" 3/4"	VW-Double		

## BSPP Porting (pump)

1 1/2" 1 1/4"	FN	NF
1 1/2" 1"	FP	PF
1 1/4" 1 1/4"	FR	RF
1 1/4" 1"	FS	SF
1" 1"	FT	TF
1 1/2" -	BP	PB
1 1/4" -	BQ	QB
1" -	BR	RB
- 1 1/4"	BT	TB
- 1"	BU	UB

## BSPP Porting (motor)

1 1/4" 1 1/4"	VX-Double
1" 1"	VY-Double
3/4" 3/4"	VZ-Double

## Gear Housing (6)

<b>AB</b>	Pump
<b>EB</b>	Motor

## Gear Width (7)

	Gear Width	in. <sup>3</sup> /rev.	cm <sup>3</sup> /rev.	Max Pressure
<b>07</b>	3/4"	2.70	44.3	3500psi (241 bar)
<b>10</b>	1"	3.60	59.0	3500psi (241 bar)
<b>12</b>	1 1/4"	4.50	73.8	3500psi (241 bar)
<b>15</b>	1 1/2"	5.40	88.5	3500psi (241 bar)
<b>17</b>	1 3/4"	6.30	103.3	3500psi (241 bar)
<b>20</b>	2"	7.20	118.0	3500psi (241 bar)
<b>22</b>	2 1/4"	8.10	132.8	3250psi (224 bar)
<b>25</b>	2 1/2"	9.00	147.5	3000psi (207 bar)

## IN OUT CW CCW

IN	OUT	CW	CCW
<b>OD Tube Porting (pump)</b>			
1 1/2" 1 1/4"	FB	BF	
1 1/2" 1"	FC	CF	
1 1/4" 1 1/4"	FG	GF	
1 1/4" 1"	FJ	JF	
1" 1"	FL	LF	
1 1/2" -	BC	CB	
1 1/4" -	BG	GB	
1" -	BJ	JB	
- 1 1/4"	BL	LB	
- 1"	BN	NB	

## OD Tube Porting (motor)

1 1/4" 1 1/4"	VC-Double
1" 1"	VN-Double
3/4" 3/4"	VR-Double

## Unported (pump)

Unported	BI	IB
----------	----	----

## Unported (motor)

BA	Unported
----	----------

## Shaft Type (8)

(For Single, Tandem or Two-piece Units -unless noted)

07 SAE "C" Spline (single and tandem only)

11 SAE "C" Keyed

25 SAE "B" Spline (single only)

## Bearing Carriers (9)

### (Dual Outlet - Pump Only)

Outlets: for clockwise porting the top port number comes first;  
for counter-clockwise porting the bottom port number comes first.

IN	OUT	CW	CCW	IN	OUT	CW	CCW
	^				^		
<b>SAE Split Flange</b>							
2 1/2"	1 1/2"	1 1/2"	AC	CA			
2 1/2"	1 1/2"	1 1/4"	AD	DA			
2 1/2"	1 1/2"	1"	AE	EA			
2 1/2"	1 1/4"	1 1/4"	AF	FA			
2 1/2"	1 1/4"	1"	AG	GA			
2 1/2"	1"	1"	AH	HA			
2"	1 1/2"	1 1/2"	AJ	JA			
2"	1 1/2"	1 1/4"	AK	KA			
2"	1 1/2"	1"	AL	LA			
2"	1 1/4"	1 1/4"	AM	MA			
2"	1 1/4"	1"	AN	NA			
2"	1"	1"	AP	PA			
1 1/2"	1 1/2"	1 1/2"	AQ	QA			
1 1/2"	1 1/2"	1 1/4"	AR	RA			
1 1/2"	1 1/2"	1"	AS	SA			
1 1/2"	1 1/4"	1 1/4"	AT	TA			
1 1/2"	1 1/4"	1"	AU	UA			
1 1/2"	1"	1"	AV	VA			
1 1/4"	1 1/4"	1 1/4"	AW	WA			
1 1/4"	1 1/4"	1"	AX	XA			
1 1/4"	1"	1"	AY	YA			
1"	1"	1"	AZ	ZA			
<b>OD Tube Porting</b>							
2"	1 1/2"	1 1/2"	GJ	JG			
2"	1 1/2"	1 1/4"	GK	KG			
2"	1 1/2"	1"	GL	LG			
2"	1 1/4"	1 1/4"	GM	MG			
2"	1 1/4"	1"	GN	NG			
2"	1"	1"	GP	PG			
1 1/2"	1 1/2"	1 1/2"	GQ	QG			
1 1/2"	1 1/2"	1 1/4"	GR	RG			
1 1/2"	1 1/2"	1"	GS	SG			
1 1/2"	1 1/4"	1 1/4"	GT	TG			
1 1/2"	1 1/4"	1"	GU	UG			
1 1/2"	1"	1"	GV	VG			
1 1/4"	1 1/4"	1 1/4"	GW	WG			
1 1/4"	1 1/4"	1"	GX	XG			
1 1/4"	1"	1"	GY	YG			
1"	1"	1"	GZ	ZG			
<b>BSPP Porting</b>							
2"	1 1/2"	1 1/2"	JH	HJ			
2"	1 1/2"	1 1/4"	JK	KJ			
2"	1 1/2"	1"	JL	LJ			
2"	1 1/4"	1 1/4"	JM	MJ			
2"	1 1/4"	1"	JN	NJ			
2"	1"	1"	JP	PJ			
1 1/2"	1 1/2"	1 1/2"	JQ	QJ			
1 1/2"	1 1/2"	1 1/4"	JR	RJ			
1 1/2"	1 1/2"	1"	JS	SJ			
1 1/2"	1 1/4"	1 1/4"	JT	TJ			
1 1/2"	1 1/4"	1"	JU	UJ			
1 1/2"	1"	1"	JV	VJ			
1 1/4"	1 1/4"	1 1/4"	JW	WJ			
1 1/4"	1 1/4"	1"	JX	XJ			
1 1/4"	1"	1"	JY	YJ			
1"	1"	1"	JZ	ZJ			

## (Single Outlet - Pump Only) Outlet for front section.

IN	OUT	CW	CCW	IN	OUT	CW	CCW
<b>Metric Split Flange</b>							
2 1/2"	1 1/2"	CN	NC				
2 1/2"	1 1/4"	CP	PC				
2 1/2"	1"	CQ	QC				
2"	1 1/2"	HR	RH				
2"	1 1/4"	HS	SH				
2"	1"	HT	TH				
1 1/2"	1 1/2"	HU	UH				
1 1/2"	1 1/4"	HV	VH				
1 1/2"	1"	HW	WH				
1 1/4"	1 1/4"	HX	XH				
1 1/4"	1"	HY	YH				
1"	1"	HZ	ZH				
<b>SAE Split Flange</b>							
2 1/2"	1 1/2"	CJ	JC				
2 1/2"	1 1/4"	CL	LC				
2 1/2"	1"	CM	MC				
2"	1 1/2"	HB	BH				
2"	1 1/4"	HC	CH				
<b>OD Tube Porting</b>							
2"	1 1/2"	KB	BK				
2"	1 1/4"	KC	CK				
2"	1"	KF	FK				
1 1/2"	1 1/2"	KL	LK				
1 1/2"	1 1/4"	KM	MK				
1 1/2"	1"	KN	NK				
1 1/4"	1 1/4"	KO	OK				
1 1/4"	1"	KP	PK				
1"	1"	KQ	QK				
<b>BSPP Porting (motor)</b>							
1 1/2"	1 1/2"	WW	Double				
1 1/4"	1 1/4"	XX	Double				
1"	1"	YY	Double				
3/4"	3/4"	ZZ	Double				
<b>Metric Straight Thread (motor)</b>							
1 1/2"	1 1/2"	SS	Double				
1 1/4"	1 1/4"	TT	Double				
1"	1"	UU	Double				
3/4"	3/4"	VV	Double				
<b>Common Inlet Passage</b>							
No Ports						C	D
<b>Connecting Shaft (10)</b>							
For connecting tandem units.							
1 Connecting Shaft							
<b>OD Tube Porting (motor)</b>							
1 1/2"	1 1/2"	MM	Double				
1 1/4"	1 1/4"	NN	Double				
1"	1"	QQ	Double				
3/4"	3/4"	RR	Double				

\* Outlet port for rear section.

# 400 Series Pumps

Commercial's P400 series of high pressure, fixed displacement gear pumps are available in single and multiple assemblies. These units are rated for service up to 4500 psi. They're available in three models offering you a displacement range from 1.5 to 5.5 CIR.

These units are cast from high-strength iron which provides the structural integrity needed at high pressures. Gear widths have been selected to keep shaft deflections and bearing loads within acceptable design limits. Body seals have been strengthened and the fastener pre-load increased to assure reliability under high pressure conditions.

A wide variety of SAE B and C mounting flanges and drive shaft configurations are available. Porting is through SAE split flange or "O" ring fitting. Special hardened steel alloy gears with integral drive shaft run between pressure-balanced, bronze wear plates to make these rugged pumps highly efficient. Long shaft journals provide superior bearing surfaces and add to long service life.

Pumps can be assembled for rotation in either direction. Motors are not available as of January 1990.

## Displacement per inch of gear

P430	1.97 CIR
P450	2.55 CIR
P465	3.60 CIR

## Performance Data

The performance data shown on the adjacent page are the average results based on a series of laboratory tests of production units and are not necessarily representative of any one unit. Tests were run at 4500 psi with the oil reservoir temperature at 180° F and viscosity of 150 SUS @ 100.

## Oil Recommendations

Commercial's pumps work well on most good hydraulic oil as well as synthetic and fire resistant fluids. Please check with our product support department before using any fire resistant or non-petroleum based fluid. Some of these products require special seals.

- Viscosity – 50 SUS min. @ operating temperature.
- 7500 SUS max. @ starting temperature
- Viscosity index – 90 minimum
- Aniline point – 175 minimum
- Additives – Foam depressant
- Rust inhibitors

Maximum recommended system operating temperature is 180° F. or 83° C.

# Dimensional Data

## SINGLE UNITS

Model	A	B	C	D	
P430	6.88	5.88	4.94 + GW	6.19 + GW	Inches
	174.7	149.3	125.5 + GW	157.2 + GW	MM
P450	7.12	6.00	5.56 + GW	7.06 + GW	Inches
	108.8	152.4	141.2 + GW	179.3 + GW	MM
P465	7.38	7.25	5.81 + GW	7.31 + GW	Inches
	187.4	184.1	147.6 + GW	185.7 + GW	MM

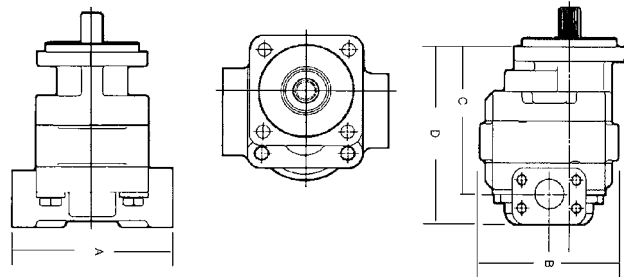

## MULTIPLE UNITS

Model	A	B	C	D	
P430	6.78	5.88	5.38 + GW	9.88 + GW	Inches
	172.2	149.3	136.7 + GW	250.9 + GW	MM
P450	7.68	6.00	5.75 + GW	10.25 + GW	Inches
	195.1	152.4	146.8 + GW	254.6 + GW	MM
P465	8.38	7.25	6.25 + GW	11.38 + GW	Inches
	212.8	184.1	158.7 + GW	289.0 + GW	MM

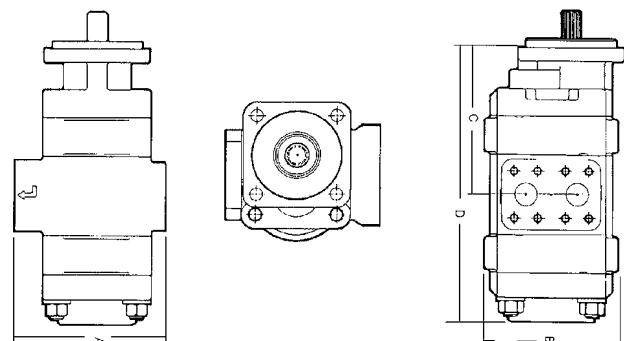

### P430 Pumps

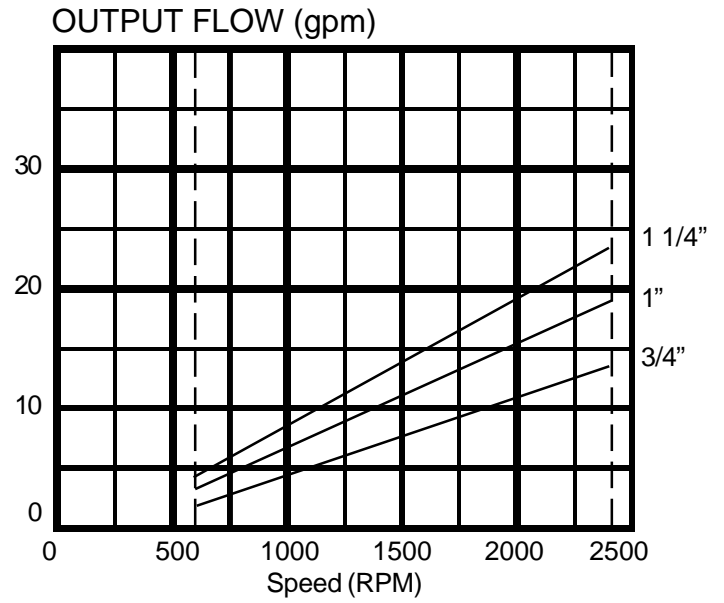
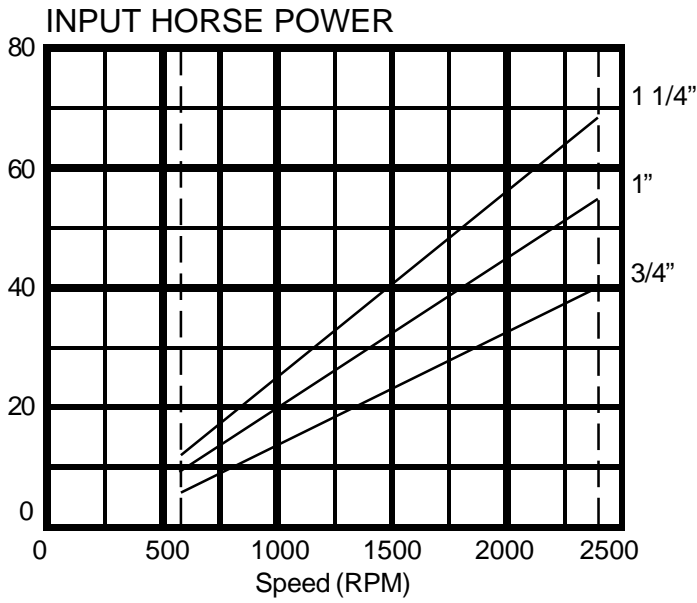

### P450 Pumps

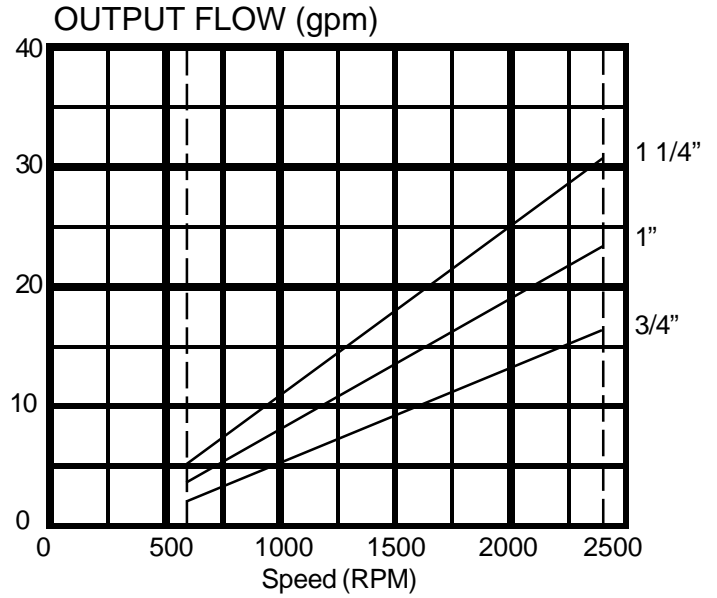
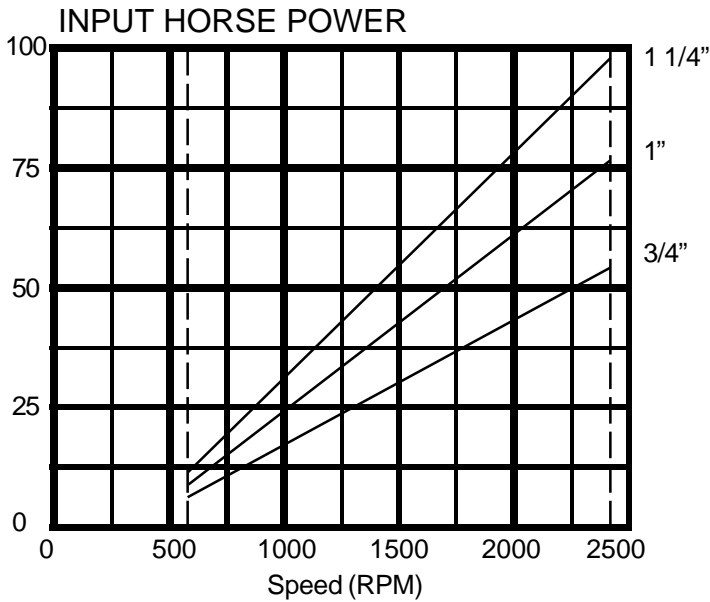

### P465 Pumps

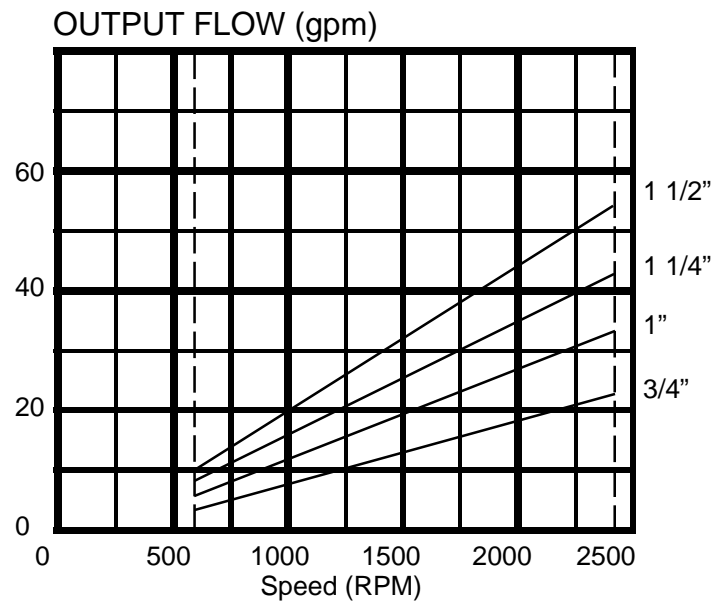
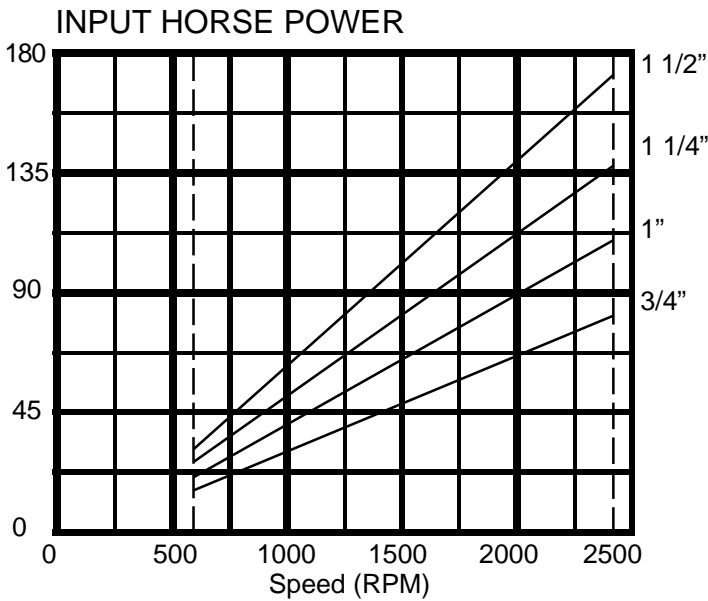

# Special Assemblies for Gear Pumps and Motors

## Contact Product Support for more information.

Commercial Intertech Corp. became the market leading manufacturer of hydraulic gear pumps for mobile equipment by anticipating customer needs and developing engineering solutions to meet them. While Commercial offers a broad range of standard gear pumps and motors for most applications, we recognize that standard equipment may not always be the best solution. Commercial Intertech is always ready and able to discuss special applications and provide practical, cost effective, well engineered solutions to your special hydraulic system needs. Here are a few examples of Commercial Intertech Corp.'s engineering and manufacturing skills.

### 315 Series - Special Assemblies

- P315/M315 gears with various drive shafts.
- P315 port end cover with built-in relief valve. Tandem use only - no inlet port available.
- P315 port end cover with side ports up to 1 1/2" S.F. inlet.
- P315 port end cover with integral priority valve. Built-in relief valve on primary circuit.
- Clutch pump mount model available.

### 330 Series - Special Assemblies

- P330 dual outlet pump bearing carrier that will accept a 2 1/2" S.F. inlet port.
- P330/M330 gears with optional number of gear teeth (10 tooth gears are standard; 13 tooth gears are optional).
- P330/M330 gears with various drive shafts and gear widths.
- P330/315 piggyback.
- P330 port end cover with side ports up to 2" S.F. inlet.
- Narrow P330 dual rotation port end cover that accepts side and/or rear ports.
- Narrow P330 port end cover that accepts side and/or rear ports.
- P330 port end cover that accepts rear threaded ports.
- P330 port end cover with integral priority valve. No relief valve on primary circuit.
- P330 pad mount shaft end cover with two drive shafts.
- P330 SAE "B" 2 bolt short shaft end cover.
- FD330 flow divider assemblies.

### 350 Series - Special Assemblies

- P350/M350 gears with optional number of gear teeth (10 tooth gears are standard; 13 tooth gears are optional).
- P350/M350 gears with various drive shafts and gear widths.
- P350/315 piggyback.
- P350 add-a-pump port end cover with the ability to mount any pump that has an SAE "A" or "B" 2 bolt mounting flange and SAE "A" or "B" splined drive shaft.
- P350 port end cover that is shorter and narrower than standard P350 PEC. Accepts 1 1/2" diameter beaded inlet tube.
- P350/M350 SAE "C" 4 bolt, ductile iron shaft end cover.
- P350/M350 SAE "B" 2 bolt short shaft end cover.
- FD350 flow divider assemblies.

### 365 Series - Special Assemblies

- P365 bearing carriers with special porting arrangements accept 3" S.F. inlet ports.
- P365/M365 gears with various drive shafts and gear widths.
- P365/330 piggyback.
- P365 add-a-pump port end cover with the ability to mount any pump that has an SAE "A" or "B" 2 bolt mounting flange and SAE "A" or "B" splined drive shaft.
- M365 SAE "C" 4 bolt, compacted graphite shaft end cover.
- FD365 flow divider assemblies.



### **P315 Tandem Pump with Integral Port End Priority Valve**



By incorporating the priority flow valve and relief valve in the port end housing, this design puts the added flow of a tandem to good use without requiring excessive mounting space for a bolt-on valve. The integral priority flow valve provides primary and secondary flow ports. Flow in excess of that required by the priority circuit may be routed to a power beyond function. These units may be used to provide power steering or braking requirements.

### **Load-sense Unloaders**

These valves may be bolted to any standard pump outlet or used in-line between the pump and a load-sense control valve. Two sizes handle flows from 0-30 gpm and 30- 60 gpm at pressures to 3500 psi. The unloader effectively modulates pump output relative to function pressure and flow requirements.



### **Charge/Lube Pump**

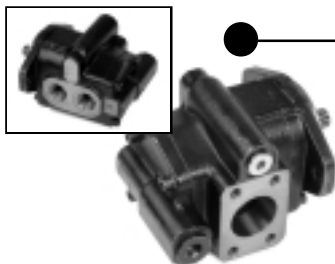

The design of this unit takes advantage of relatively low pressure operating requirements (450 psi.) to reduce the number of cast iron components required for its two pump sections from five pieces to three. Relief valves for both sections are built into the pump body. The common journal carrier, one-piece steel drive shaft, and powdered metal driven gears contribute to the overall compactness of the design while providing charge and transmission lubrication flows.

### **Through Shaft Pump**

An innovative design, this piggyback unit is driven by a common shaft that is actually the drive shaft of the machine to which it supplies two separate flows. The through shaft eliminates the need for a PTO, reduces the number of component parts and contributes to a lighter more compact machine design.



### **Pump with Shaft End Cover Ports**



The unusual shape of this pump's shaft end housing allows it to fit tight mounting spaces while maintaining smooth hydraulic line connections. The housing features integral port lobes that allow straight hydraulic line connections without line kinks or space robbing line loops. Overall length of the pump is reduced by eliminating typical gear housing ports.

### **Add-A-Pump**

This special port end housing for P350 and P365 pumps allows a separate pump to be mounted to the rear of the unit as needed for optional machine functions or to provide flow from a separate reservoir. With bearing, lip seal and drain already in place, this special can accommodate any add-on pump with SAE A or B two-bolt mounting pattern and splined drive shaft.





# Commercial Hydraulics

## AUSTRALIA

**Commercial Hydraulics**  
265 Ingles Street, P.O. Box 191  
Port Melbourne, Victoria 3207  
Phone: ++ 61 39 646 2017  
Fax: ++ 61 39 646 2257

## BRAZIL

**Commercial Intertech do Brazil**  
Rua AMF do Brazil, 251  
18120 Mairinque, Sao Paulo  
Phone: ++ 55 11 7998 2333  
Fax: ++ 55 11 7998 2099

## CANADA

**Commercial Hydraulics**  
294 Queen St. East, Suite C  
P.O. Box 450  
Acton, Ontario L7J 2M6  
Phone: ++ 519 853 0770  
Phone: ++ 519 853 3837

## FRANCE

**Commercial Hydraulics**  
Astron S.a.r.l. BP 73  
20, rue Pierre Mendès-France, Torcy  
77202 Marne La Vallée, Cedex 01  
Phone: ++ 33 1 64 62 11 00  
Fax: ++ 33 1 64 62 10 93

## GERMANY

**Commercial Hydraulics/Rochlitz**  
Dresdener Str. 115  
09326 Geringswalde  
Telefon: ++ 49 - 37382 82 0  
Fax: ++ 49 - 37382 82 210

## Commercial Hydraulics/ Sachsenhydraulik

Postfach 1153 09070 Chemnitz  
Neefstraße 96 09116 Chemnitz  
Phone: ++ 49 - 371 39 37 0  
Fax: ++ 49 - 371 30 13 88

## GREAT BRITAIN

**Commercial Hydraulics/Kontak**  
Belton Park, Londonthorpe Rd.  
Grantham NG31 9SJ, Lincolnshire  
Phone: ++ 44 1476 564105  
Fax: ++ 44 1476 592739

## Commercial Hydraulics/Ultra

Anson Business Park,  
Cheltenham Road East, Nr Staverton  
Airport, Gloucester. GL2 9QN  
Phone: ++ 44 1452 857711  
Fax: ++ 44 1452 858222

## Commercial Hydraulics/Keelavite

Tachbrook Park Drive, Tachbrook Park  
Warwick CV34 6TU  
Phone: ++ 44 1926 889 000  
Fax: ++ 44 1926 889 239

## ITALY

**Commercial Hydraulics**  
Via dell' Agricoltura I/A  
I- 37012 Bussolengo, Verona  
Phone: ++ 39 45 676 7250  
Fax: ++ 39 45 676 7229

## SWEDEN

**Commercial Hydraulics**  
Veddestavagen 24  
S-175 62 Järfälla  
Phone: ++ 46 8 445 7470  
Fax: ++ 46 8 445 7475

## USA

**Commercial Hydraulics/  
Cylinder City**  
1532 93rd Lane, N.E.  
P.O. Box 49920  
Minneapolis, Minnesota 55449  
Phone: ++ 612 780 2550  
Fax: ++ 612 780 2565

**Commercial Hydraulics/Oildyne**  
5520 North Highway 169  
Minneapolis, Minnesota 55428 4998  
Phone: ++ 612 533 1600  
Fax: ++ 612 533 0082

**Commercial Hydraulics/  
Cylinder Division**  
20138 I-30; P.O. Box 647  
Benton, Arkansas 72018 0647  
Phone: ++ 501 794 0334  
Fax: ++ 501 794 0732

**Commercial Hydraulics**  
7600 S. County Line Road, Suite #5  
Burr Ridge, Illinois 60521  
Phone: ++ 630 734 0014  
Fax: ++ 630 734 0015

**Commercial Hydraulics**  
2655 Villa Creek Drive, Suite 299  
Dallas, Texas 75234 7311  
Phone: ++ 214 241 1975  
Fax: ++ 214 241 2128

**Commercial Hydraulics/  
Controls Division**  
373 Meuse Argonne  
Hicksville, Ohio 43526  
Phone: ++ 419 542 6611  
Fax: ++ 419 542 8871

## USA

**Commercial Hydraulics/  
Pump Division**  
101 Canterbury Road, P.O. Box 219  
Kings Mountain, North Carolina  
28086  
Phone: ++ 704 739 8232  
Fax: ++ 704 739 2269

**Commercial Hydraulics/  
Pump Division**  
1775 Logan Ave.  
Youngstown, Ohio 44501  
Phone: ++ 330 740 8376  
Fax: ++ 330 740 8704

**Commercial Hydraulics/  
Cylinder Division**  
2701 Intertech Drive  
Youngstown, Ohio 44509  
Phone: ++ 330 740 8670  
Fax: ++ 330 740 8636

**Commercial Hydraulics/CEC**  
7850 Park Drive  
Chanhassen, Minnesota 55317  
Phone: ++ 612 474 0909  
Fax: ++ 612 474 7908

## CORPORATE HEADQUARTERS Commercial Intertech Corp.

1775 Logan Ave.  
Youngstown, Ohio 44501  
PO Box 239  
Phone: ++ 330 746 8011  
Fax: ++ 330 746 1148